

3.

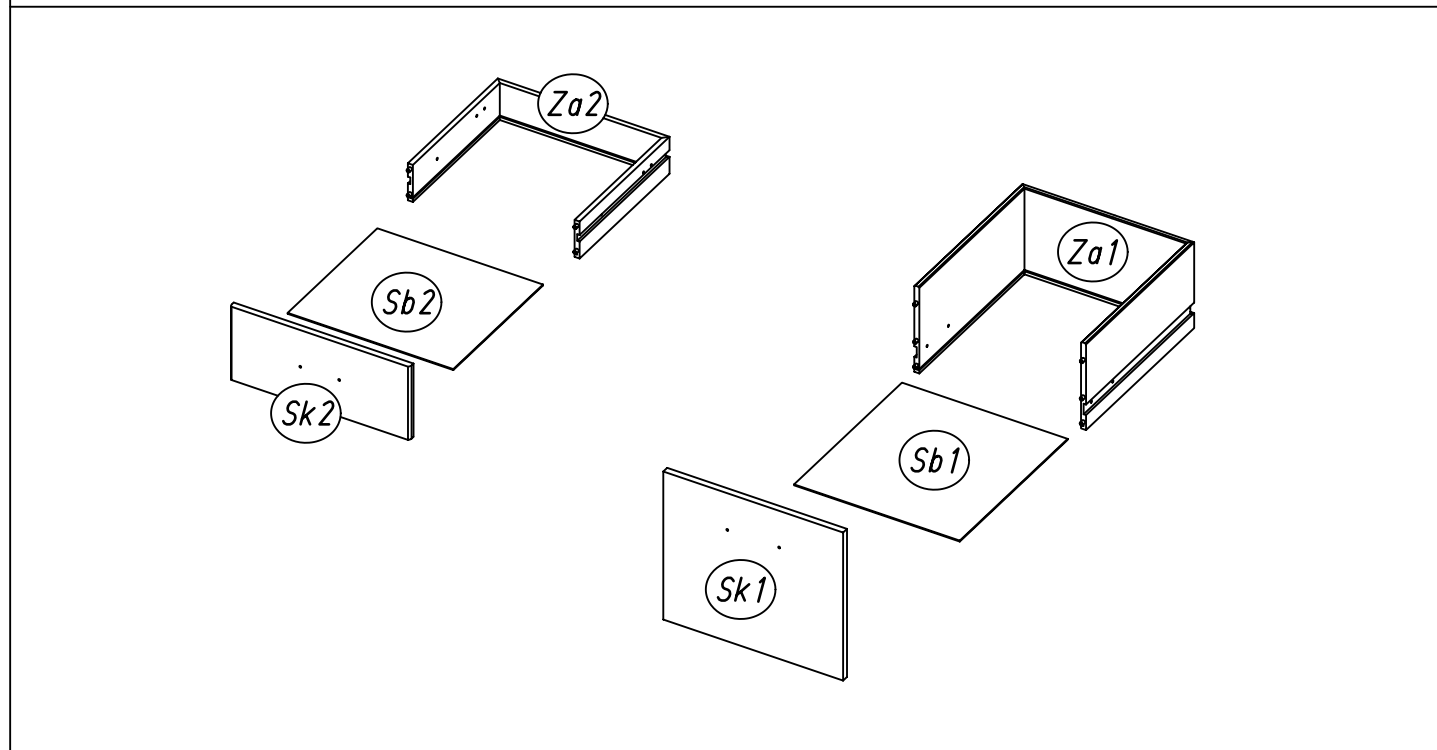

ML055

4.

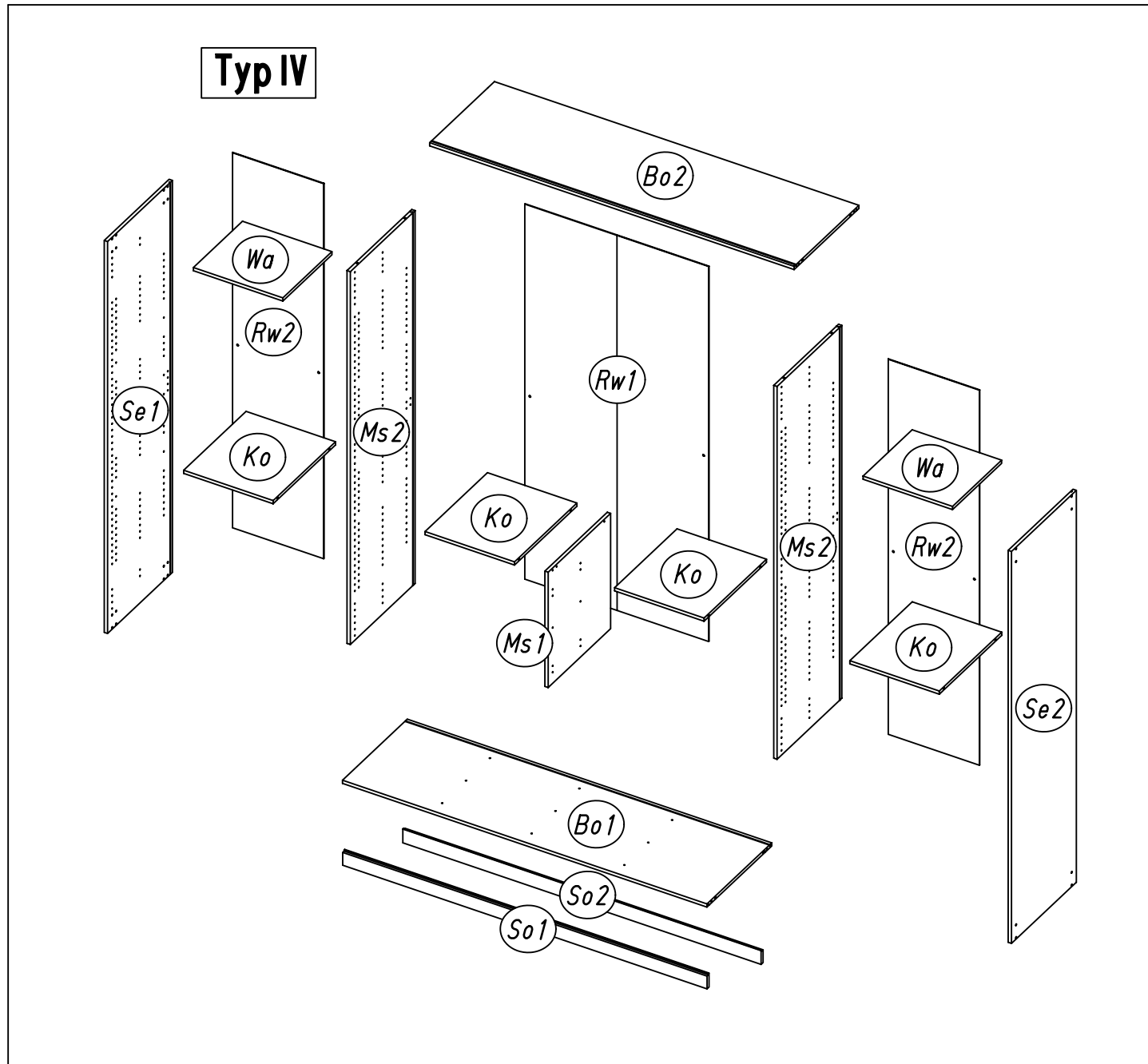
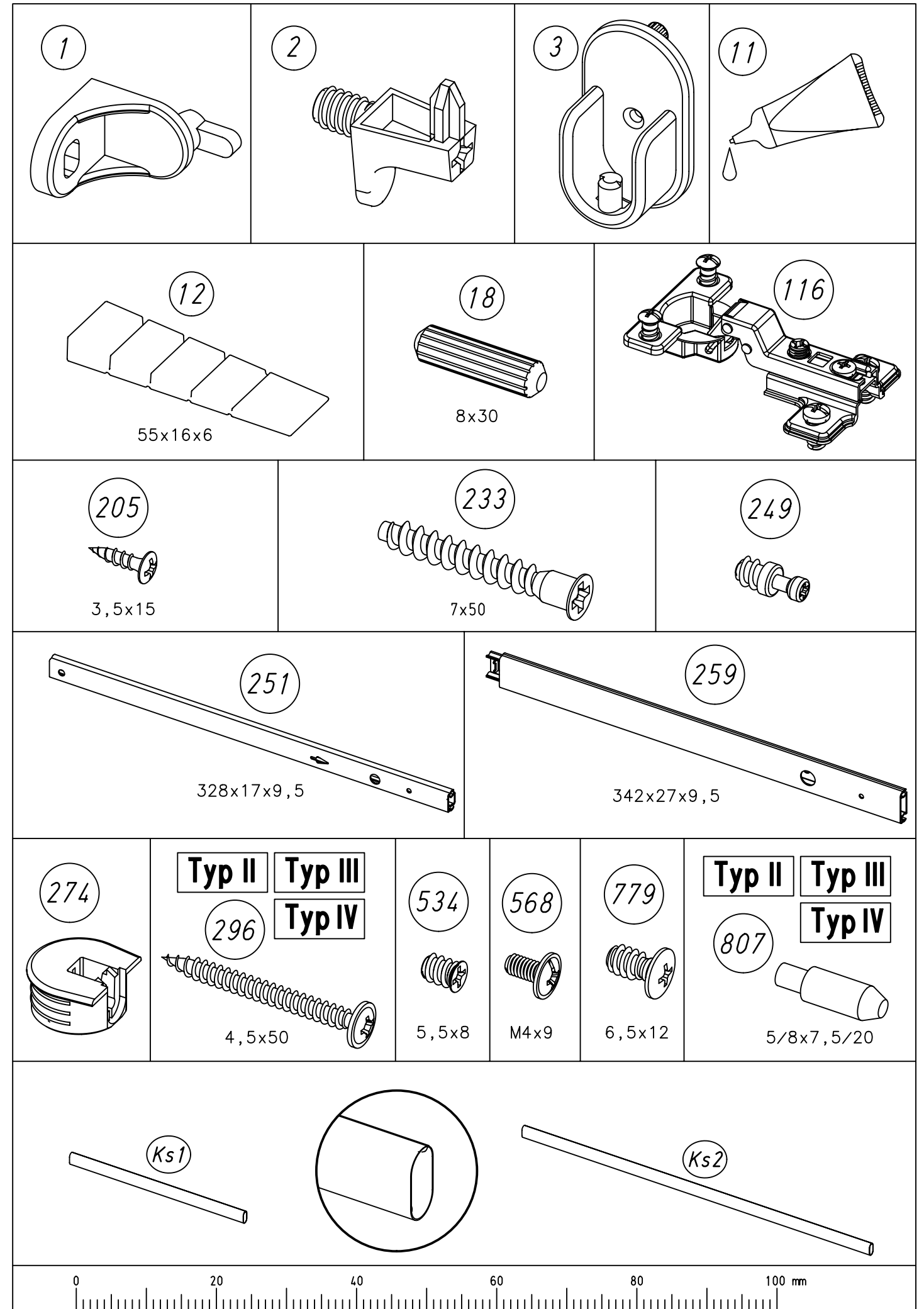

ML055

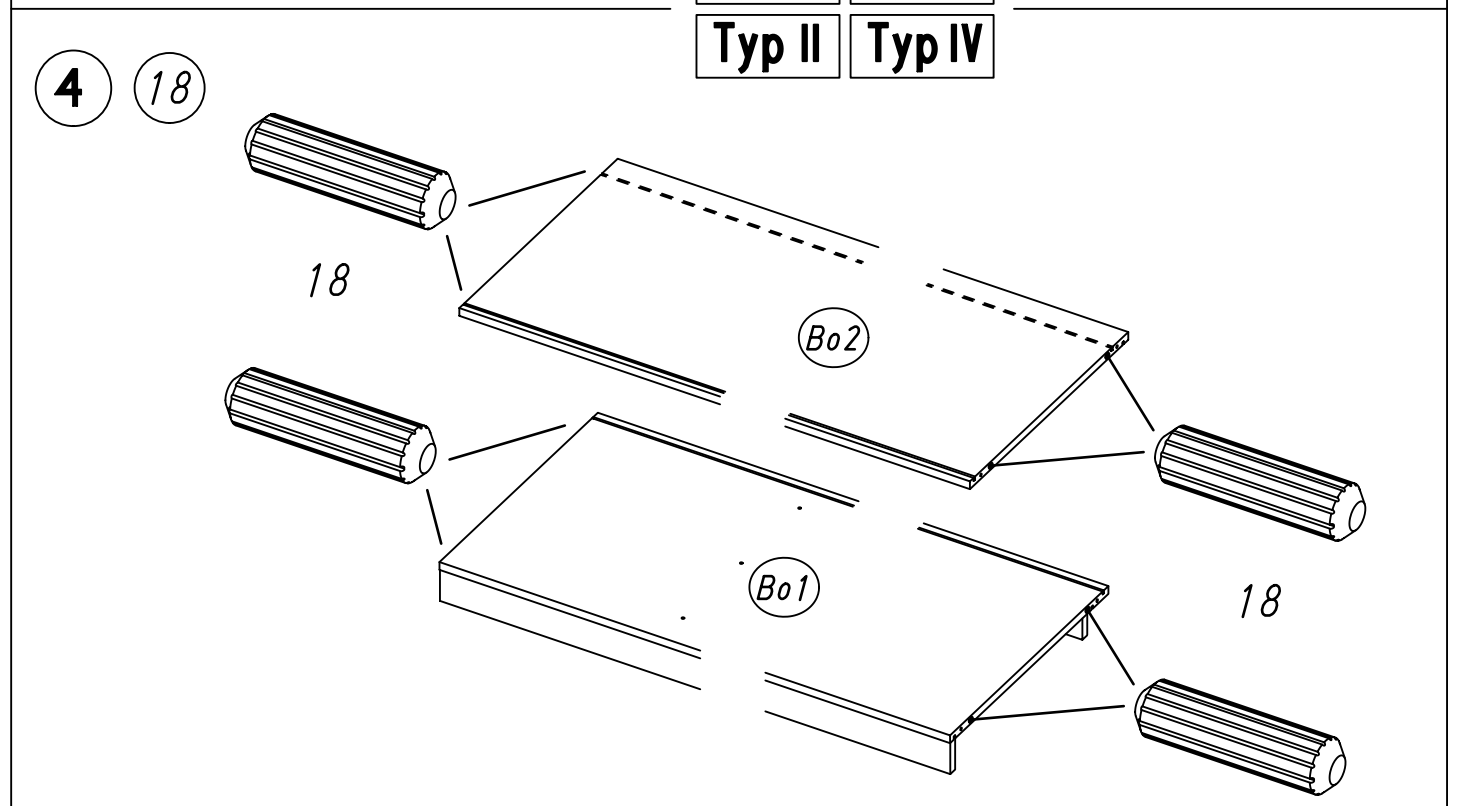
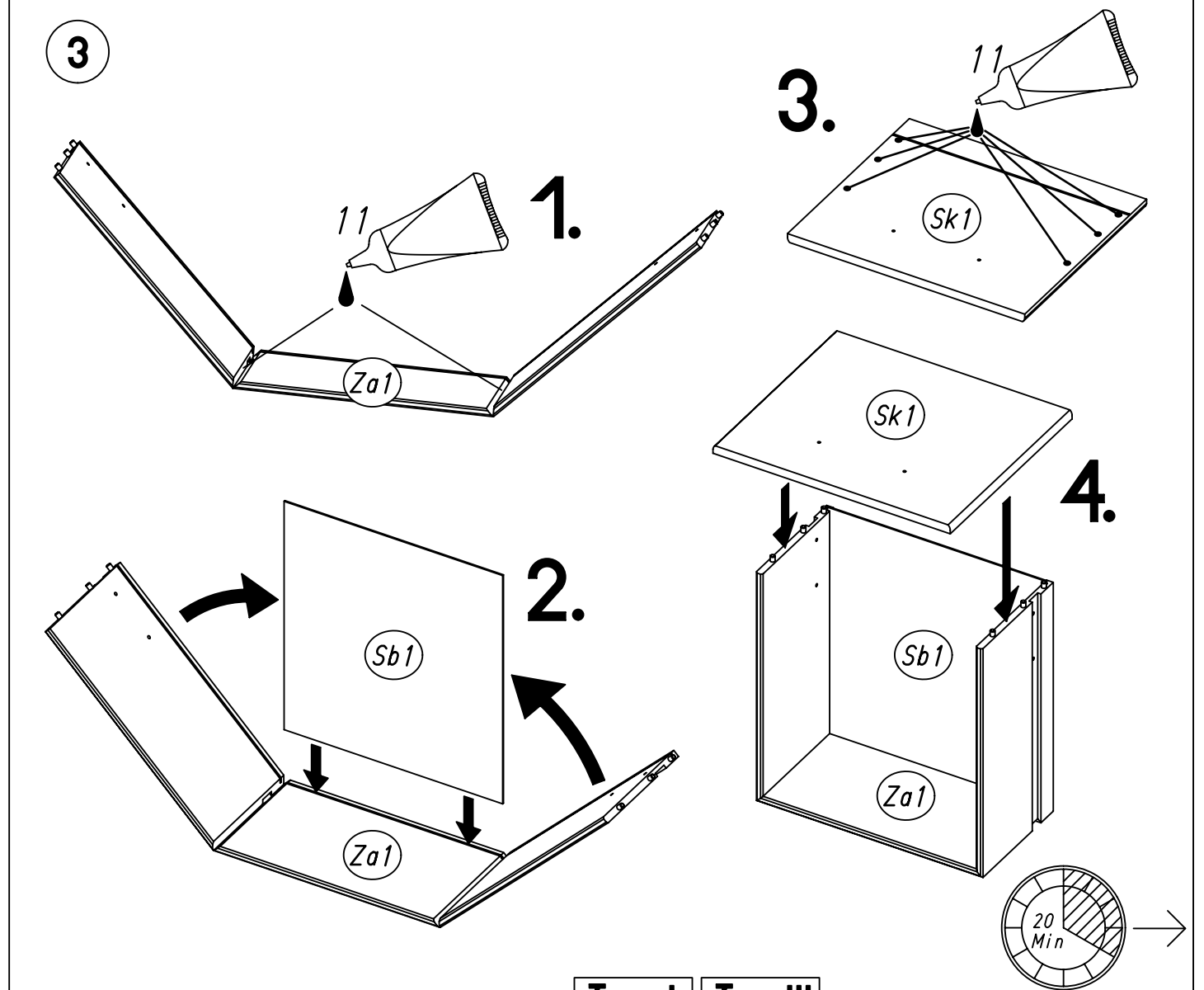
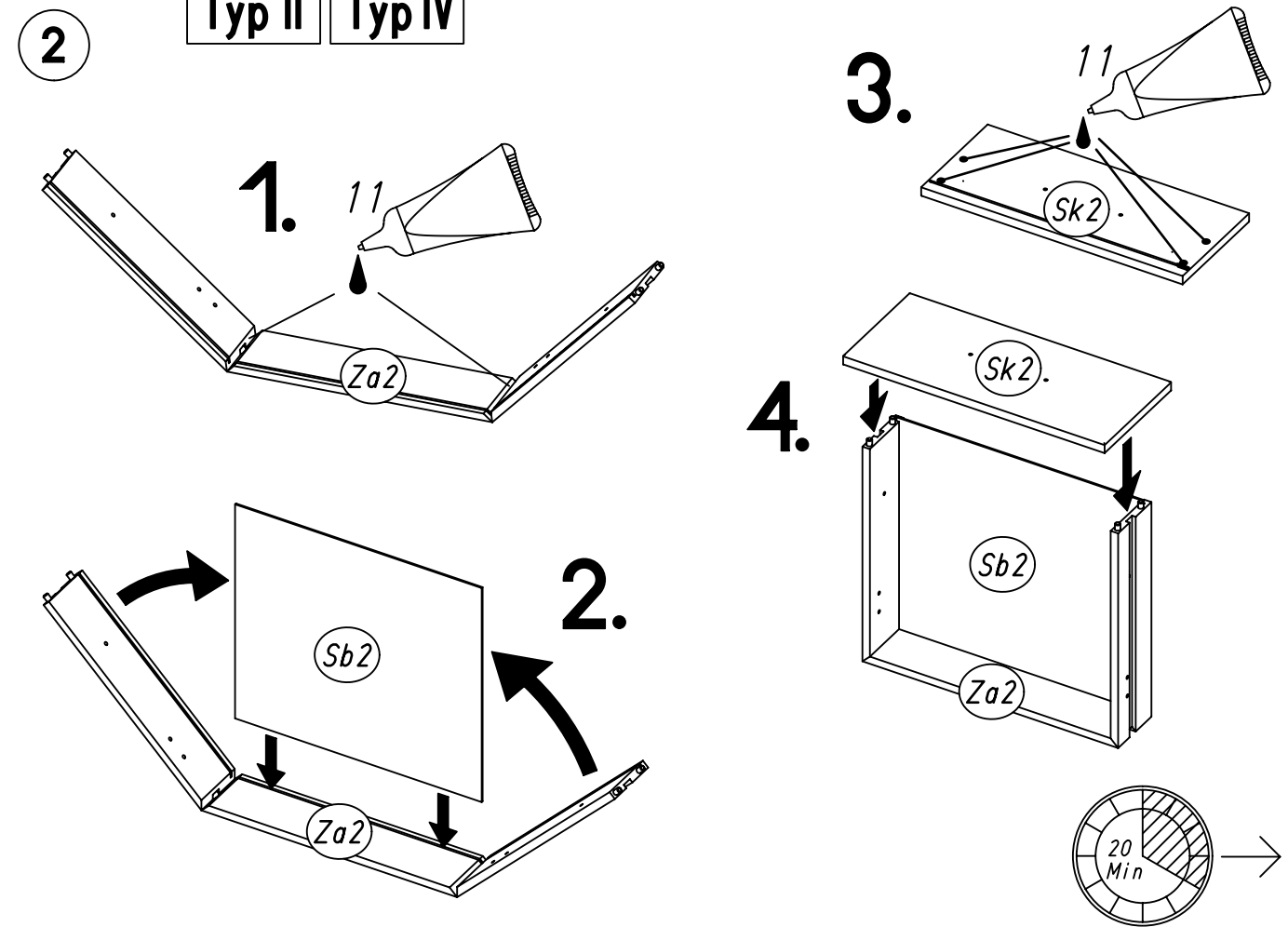
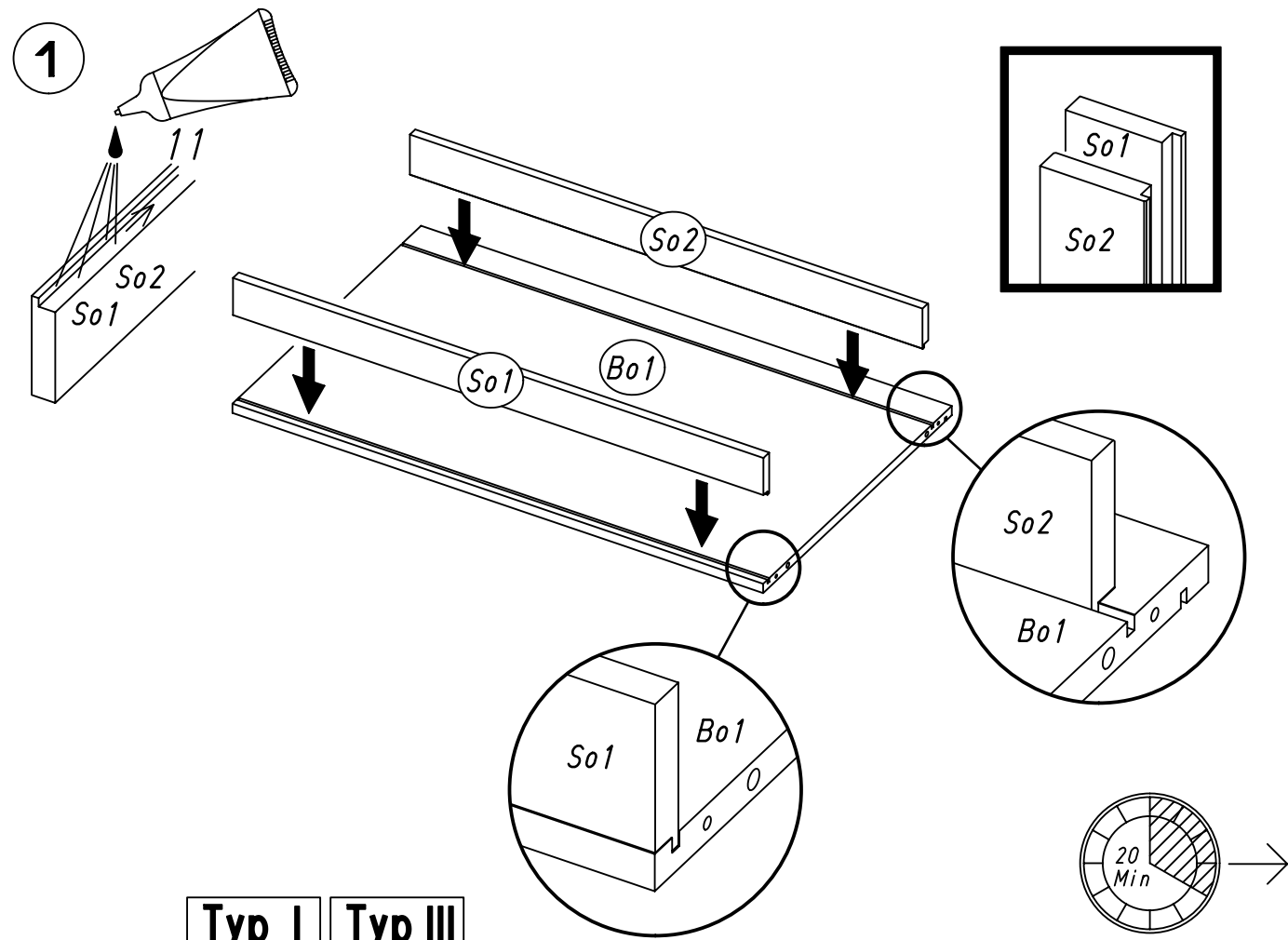

5 233

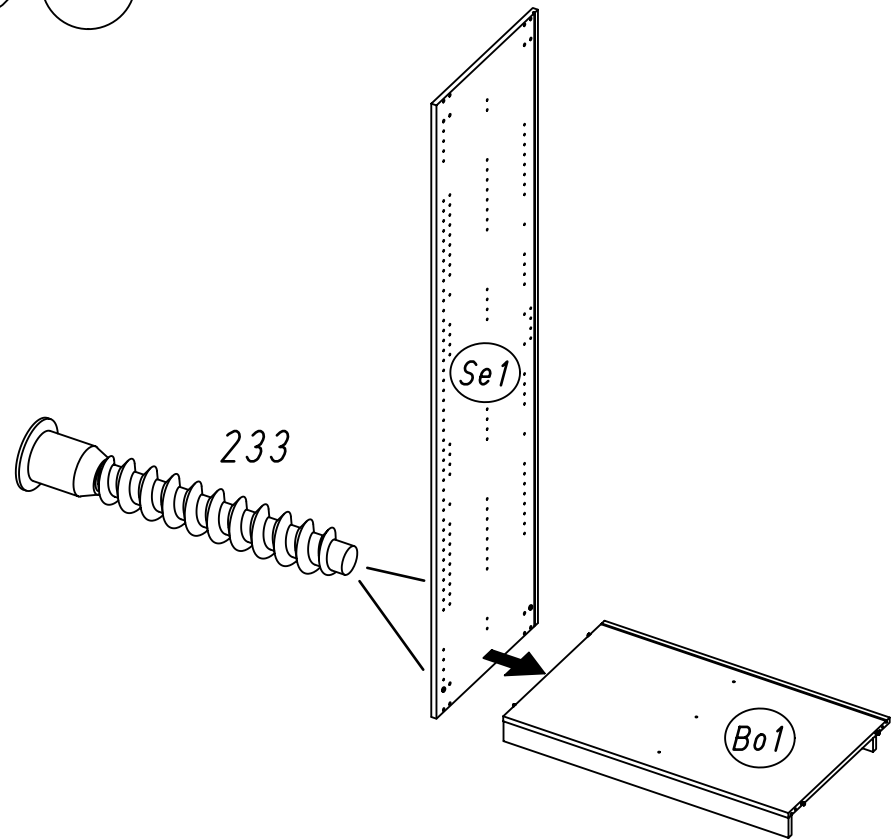

Typ I Typ II Typ III Typ IV

6 1 779

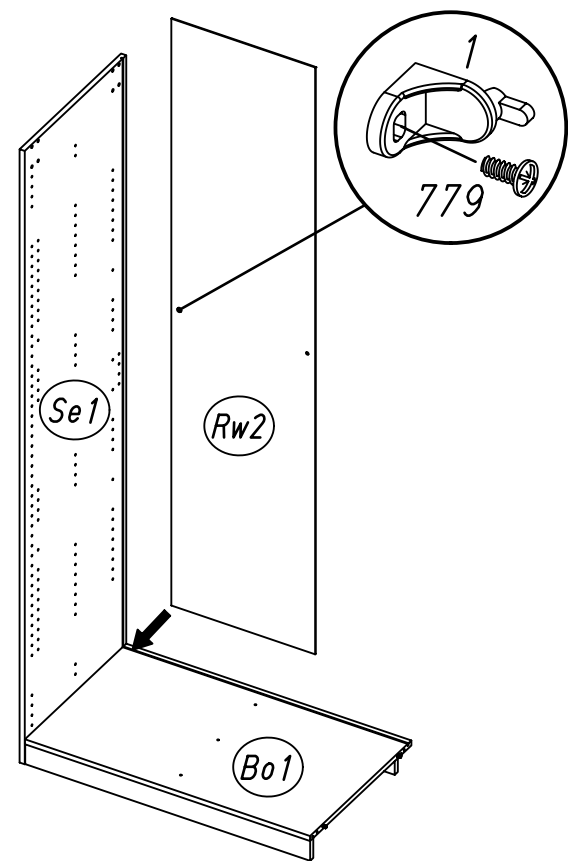

7 807 1 779

Typ II
Typ III
Typ IV

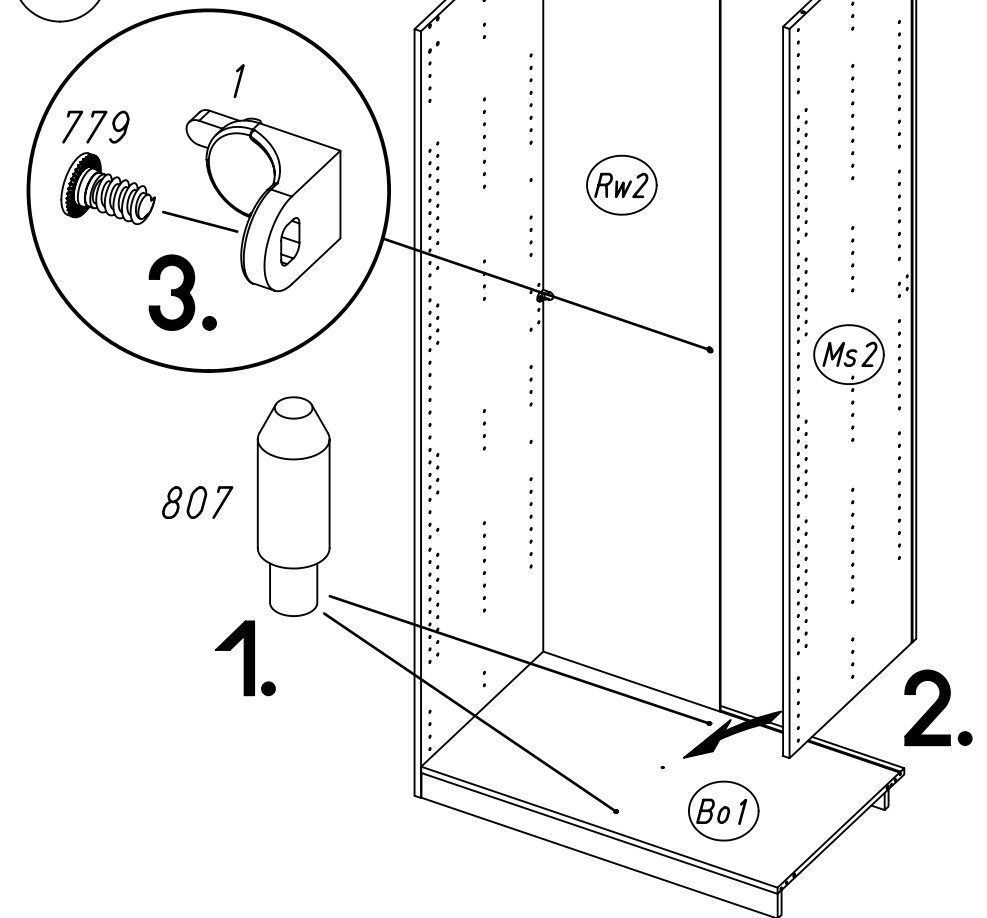

8 1 779

Typ II
Typ III

Typ IV

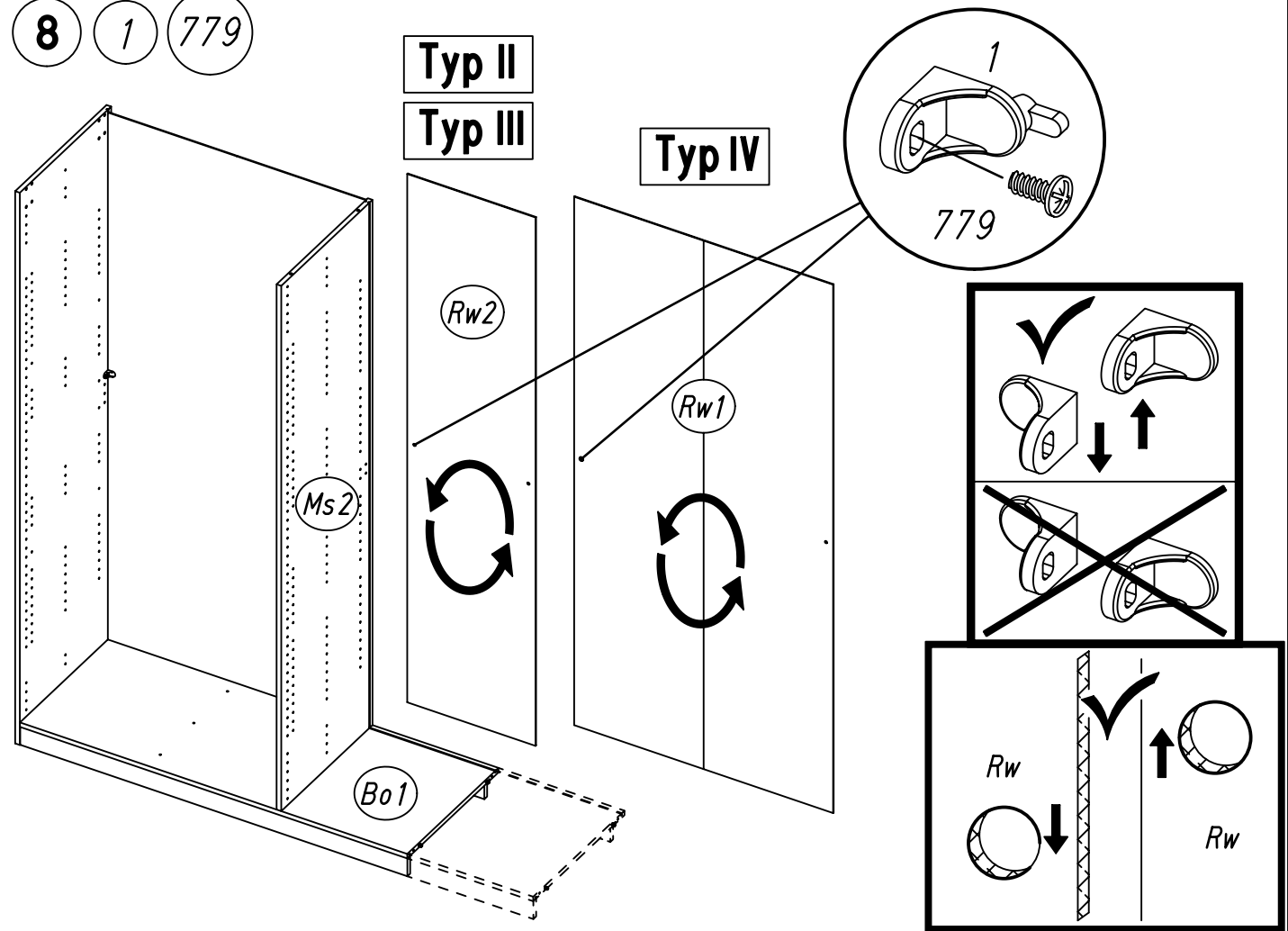

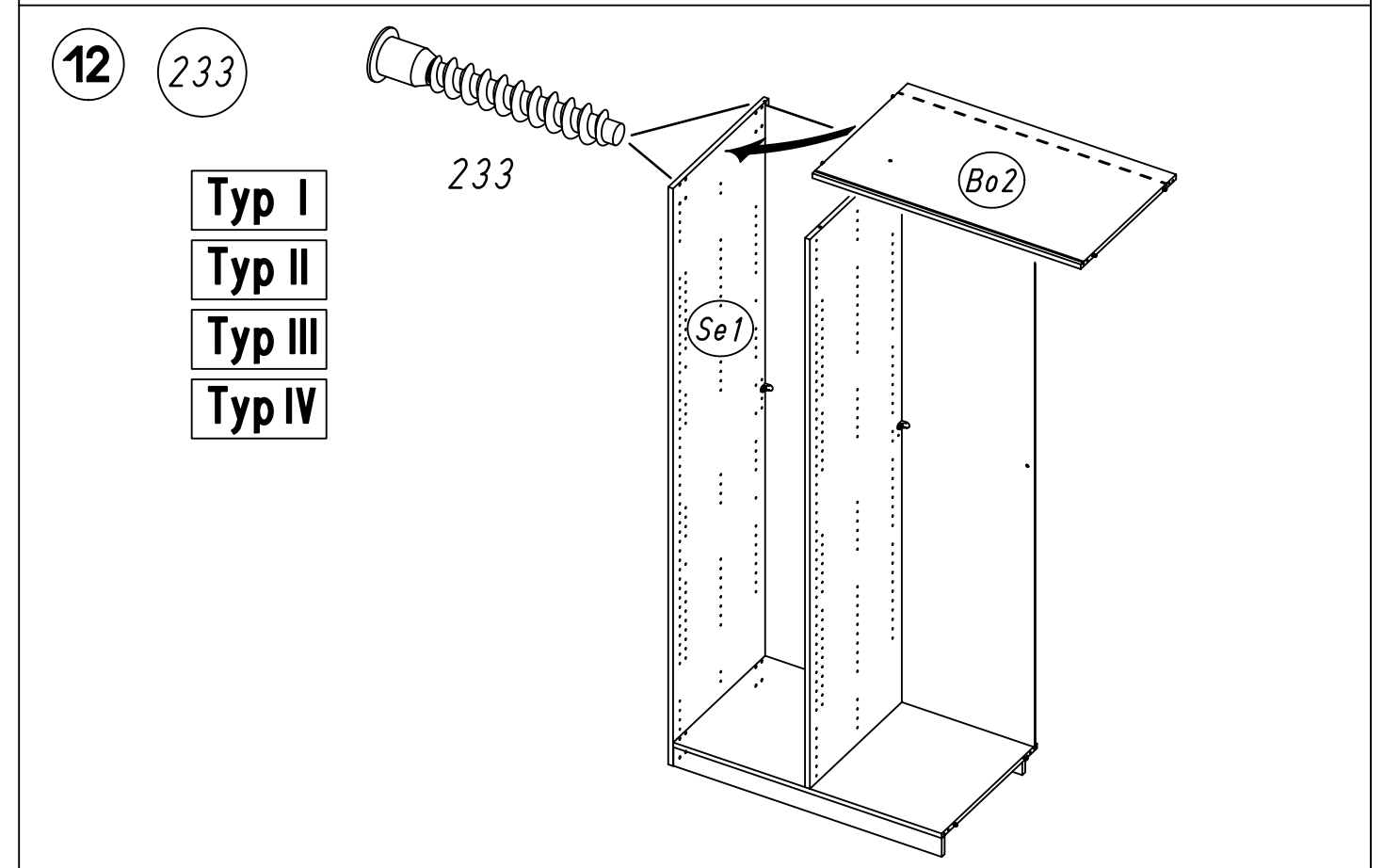
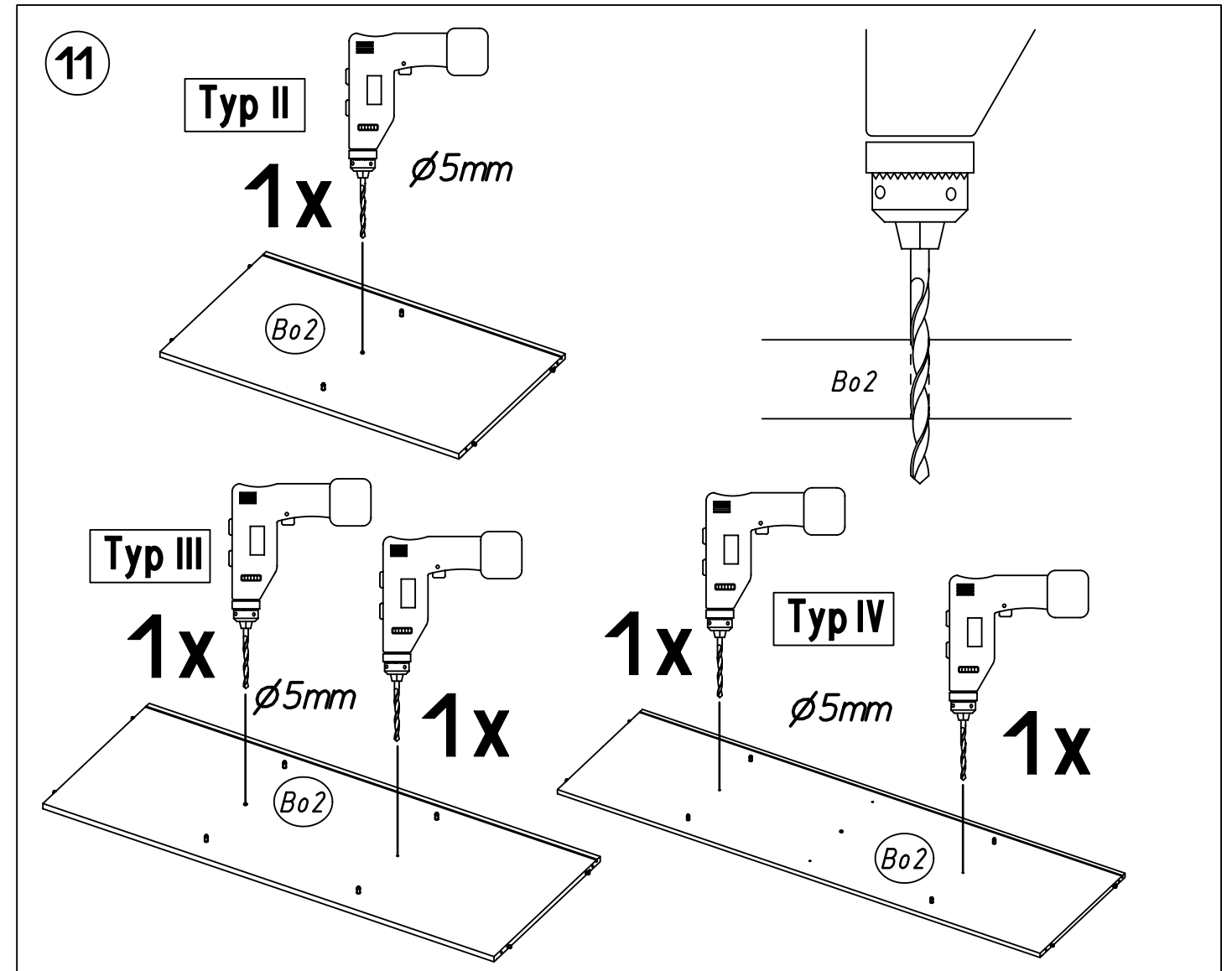
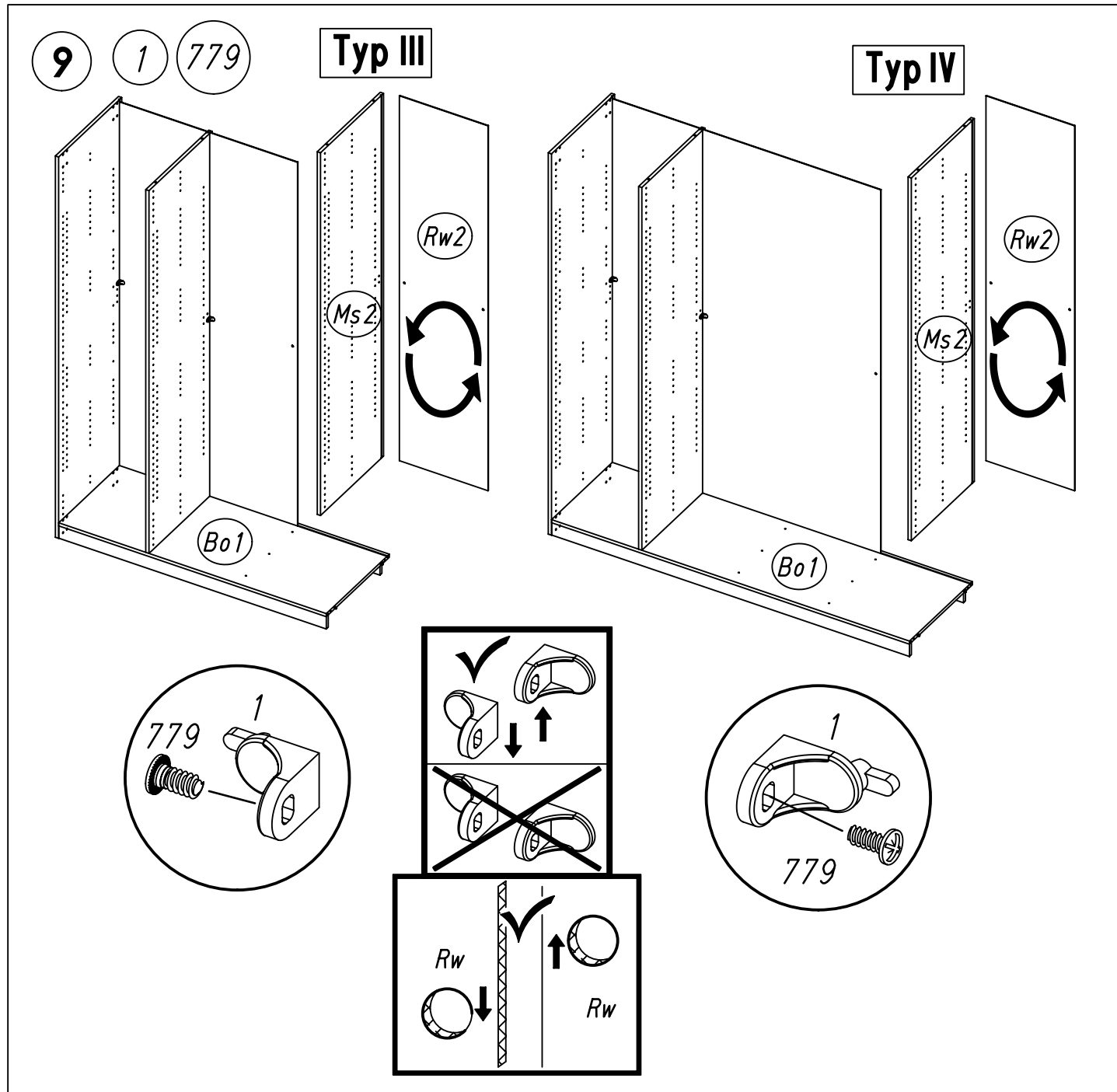

13 233

Typ I
Typ II
Typ III
Typ IV

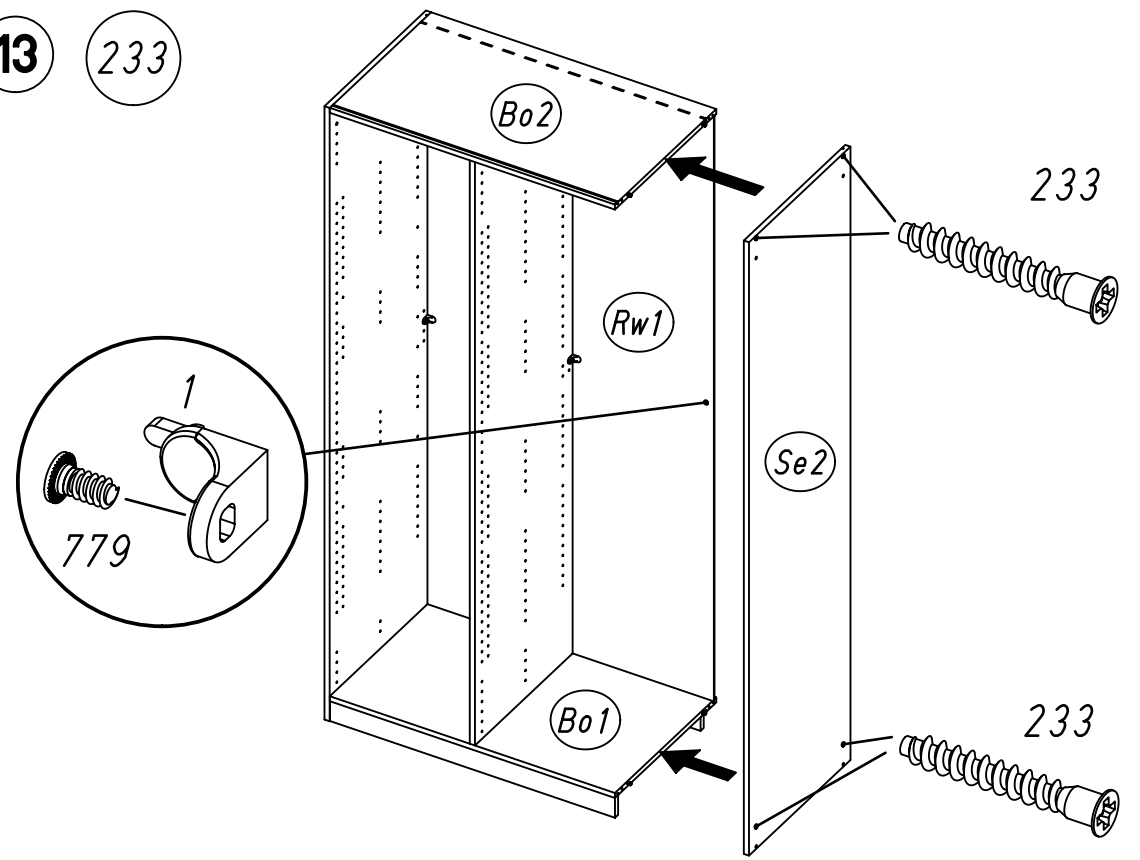

15 807

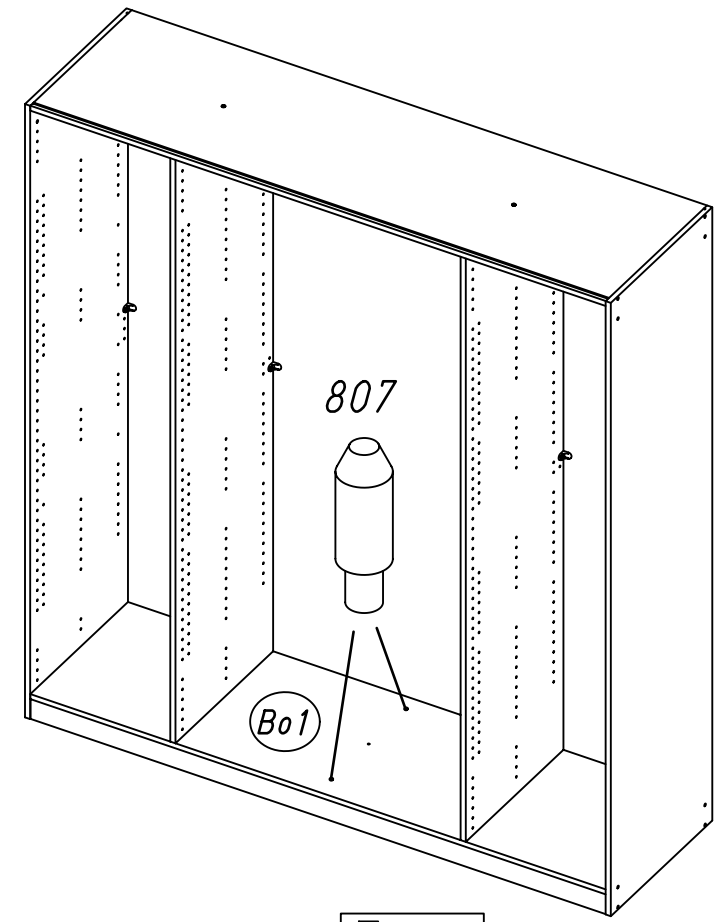

14 296

Typ II

Typ III
Typ IV

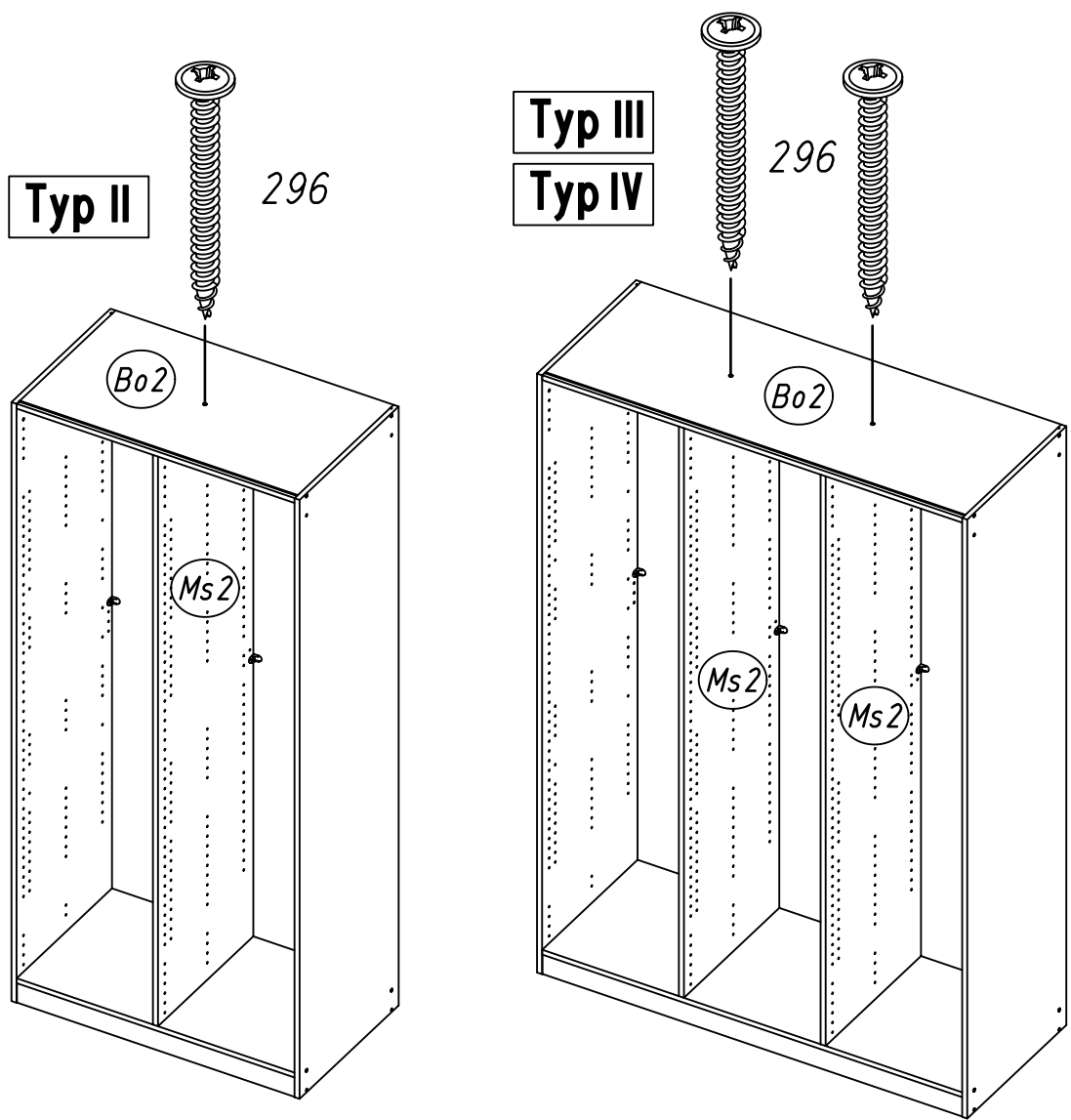

Typ IV

16 249 534 205 251 259

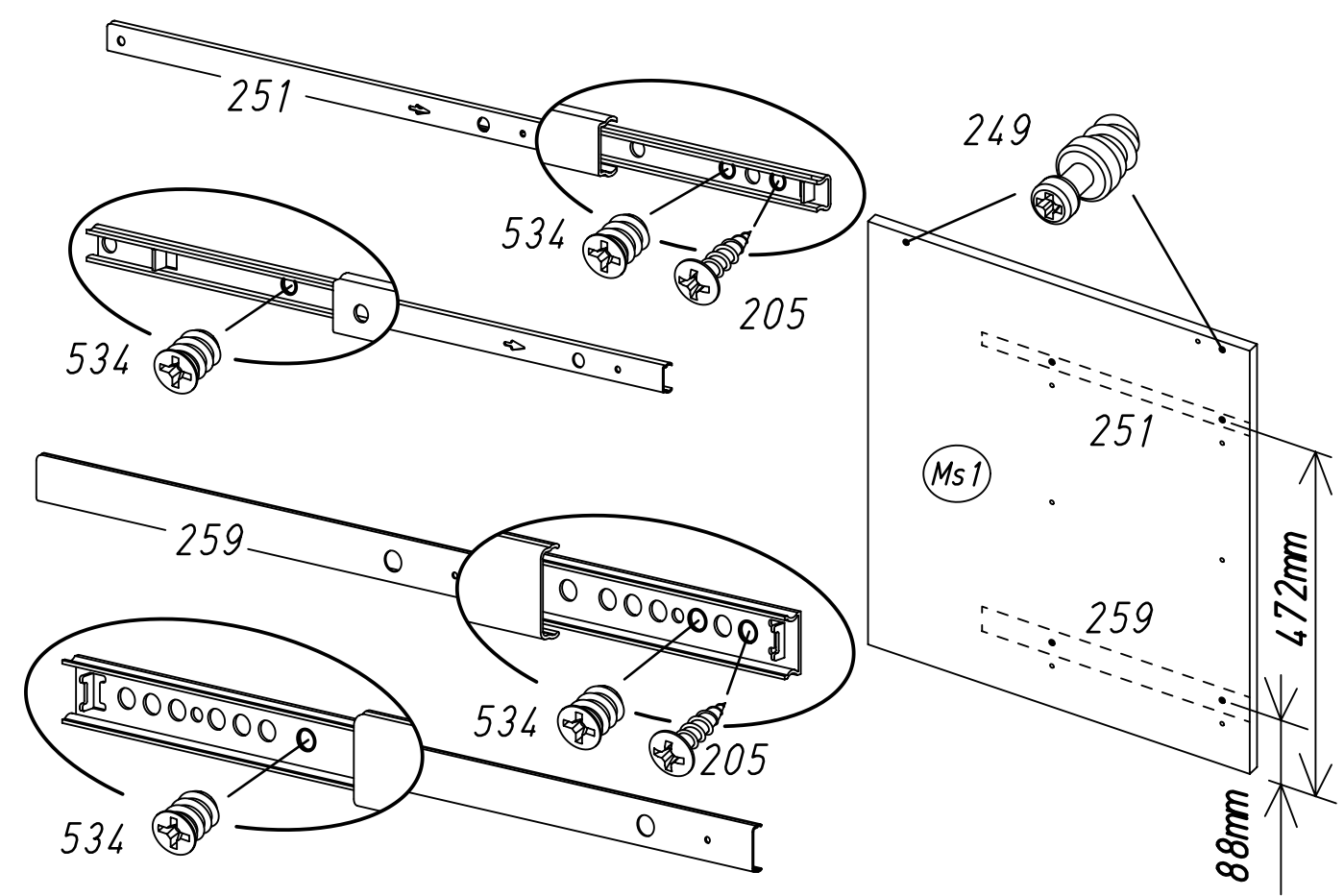

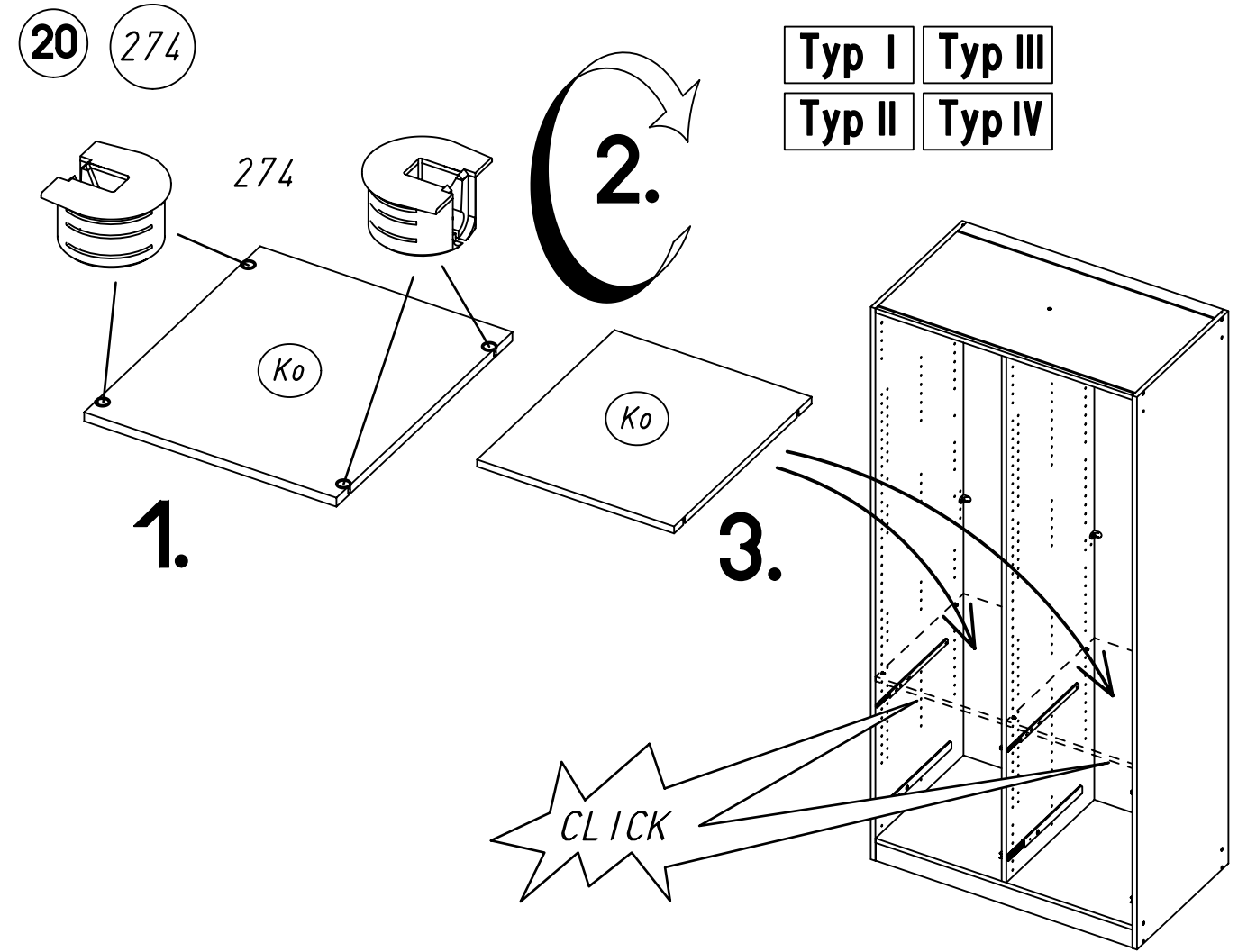
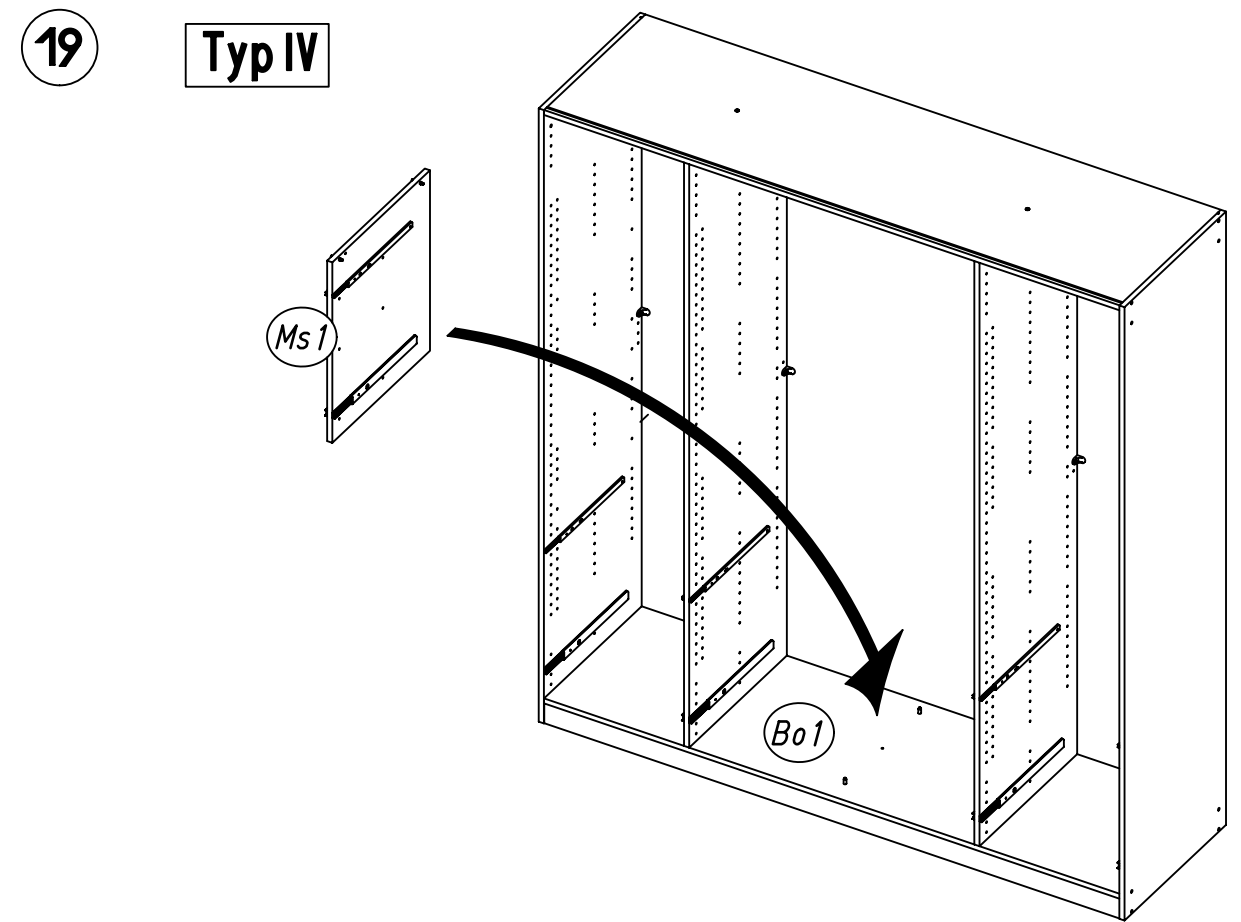
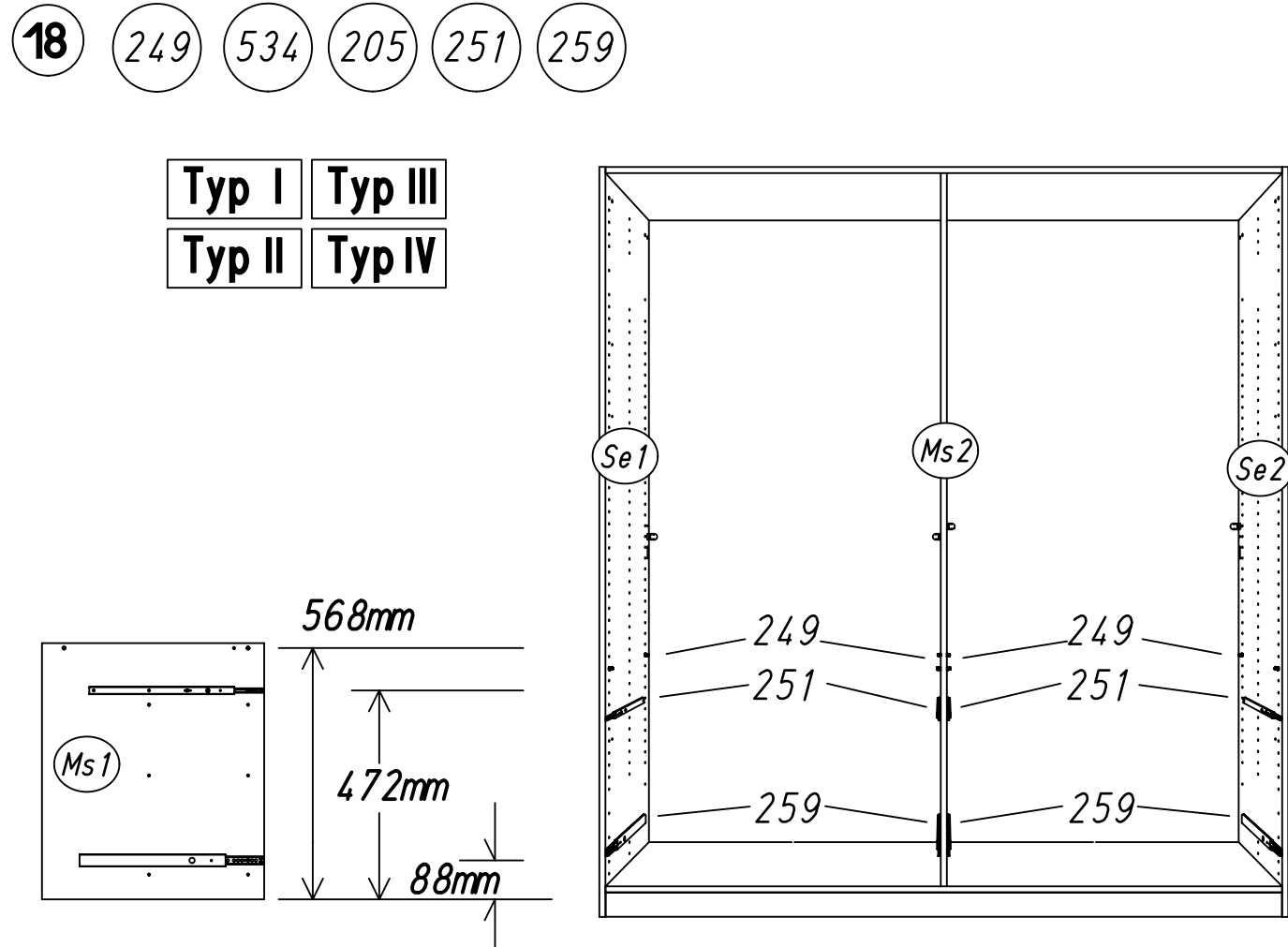
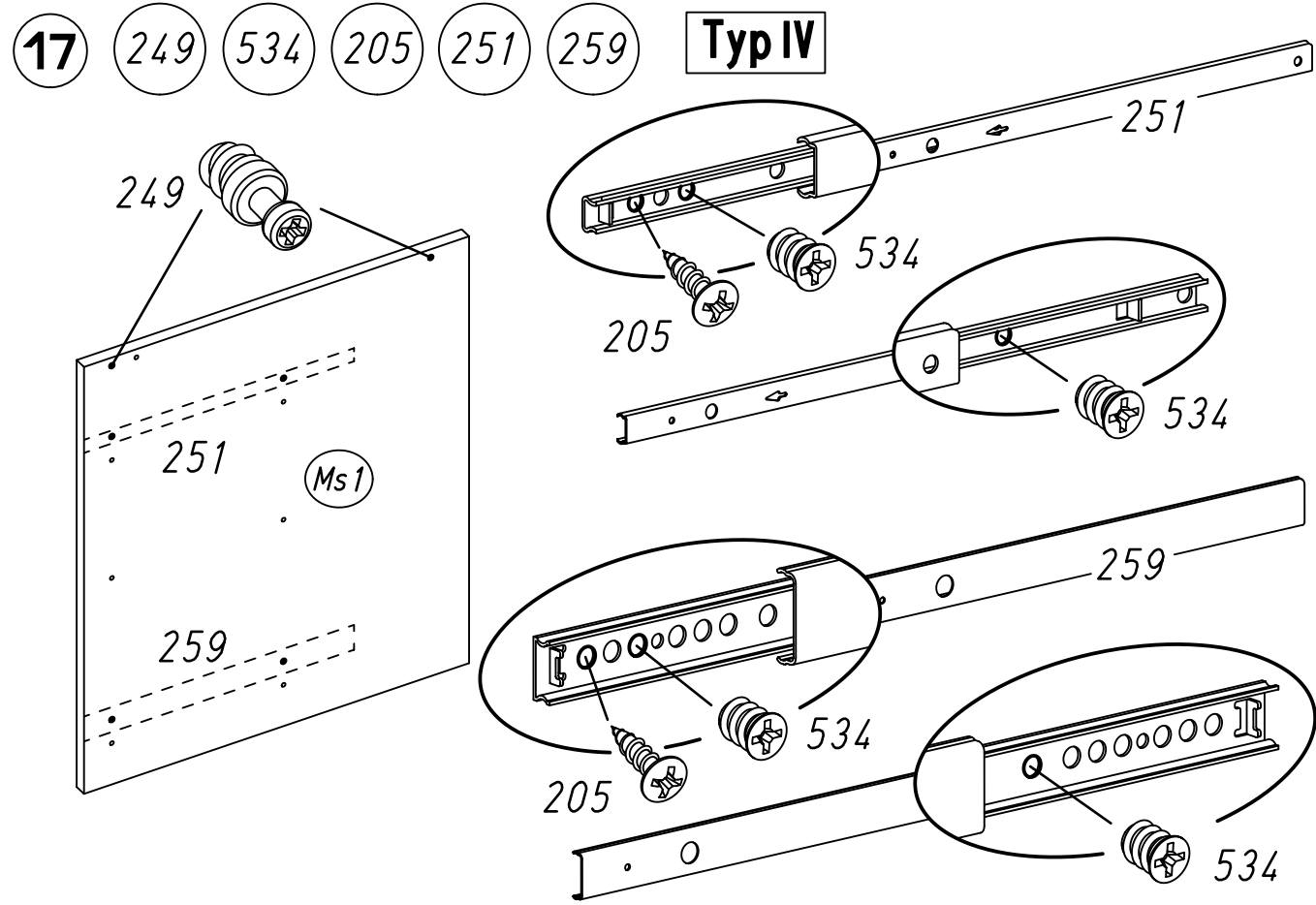

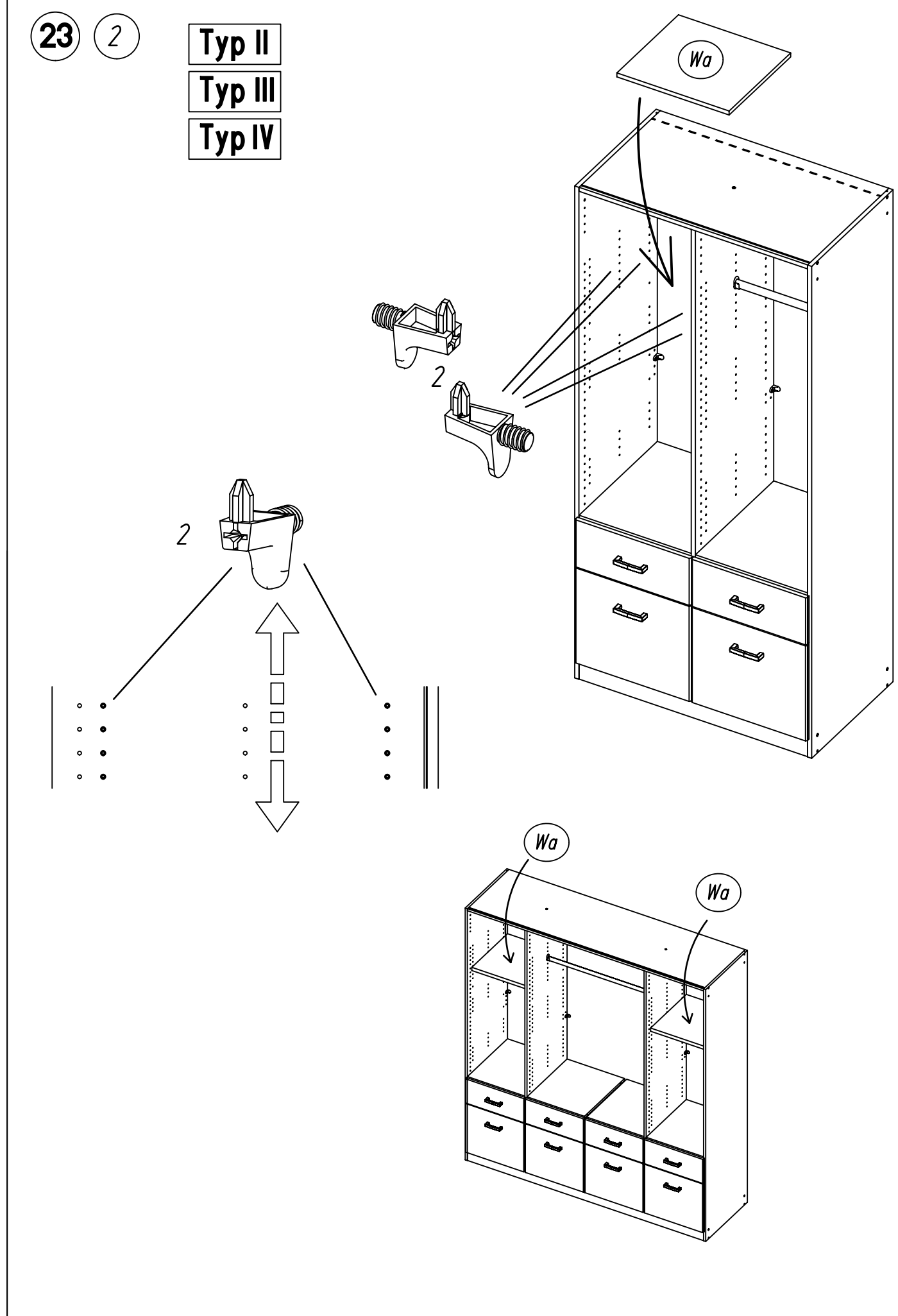
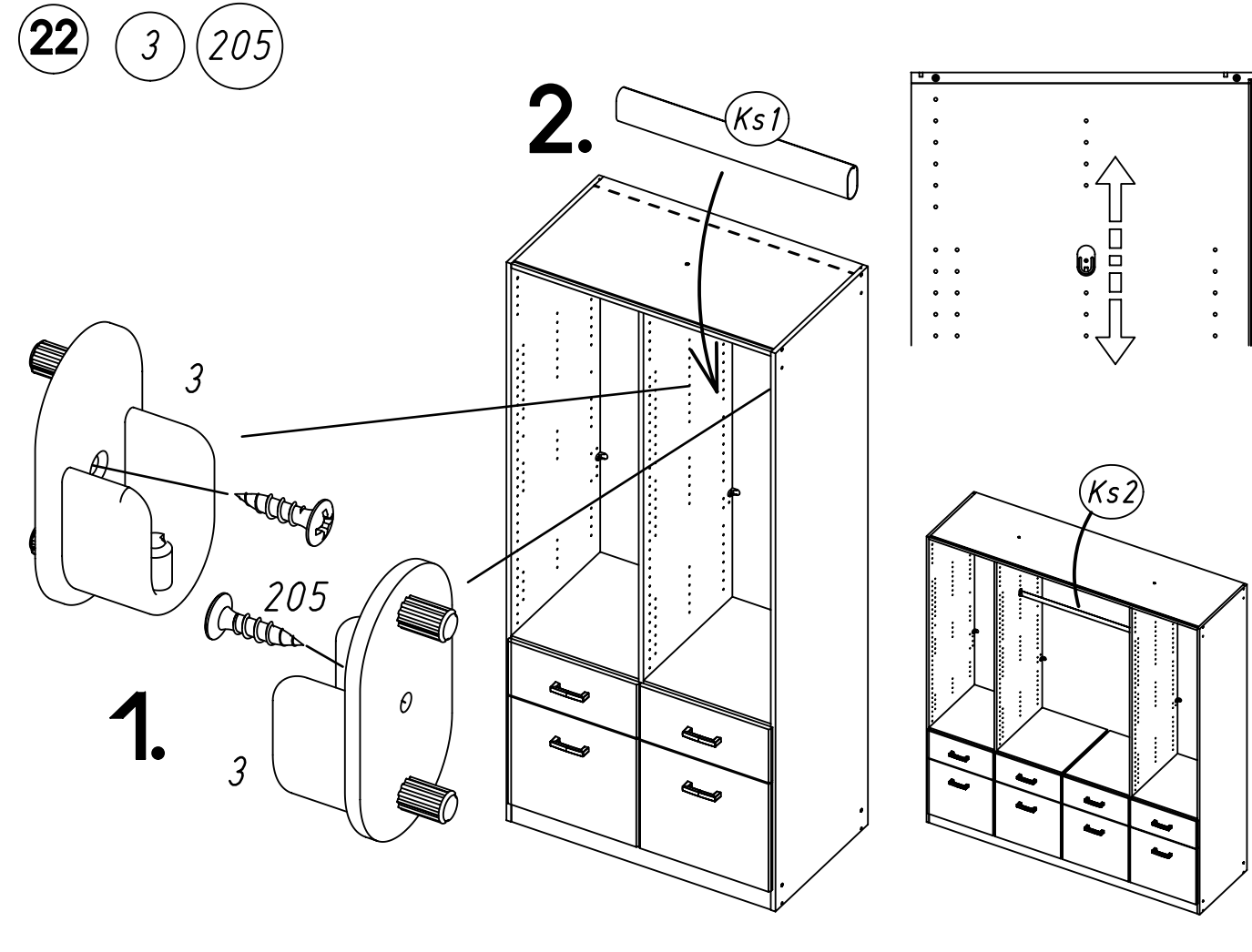
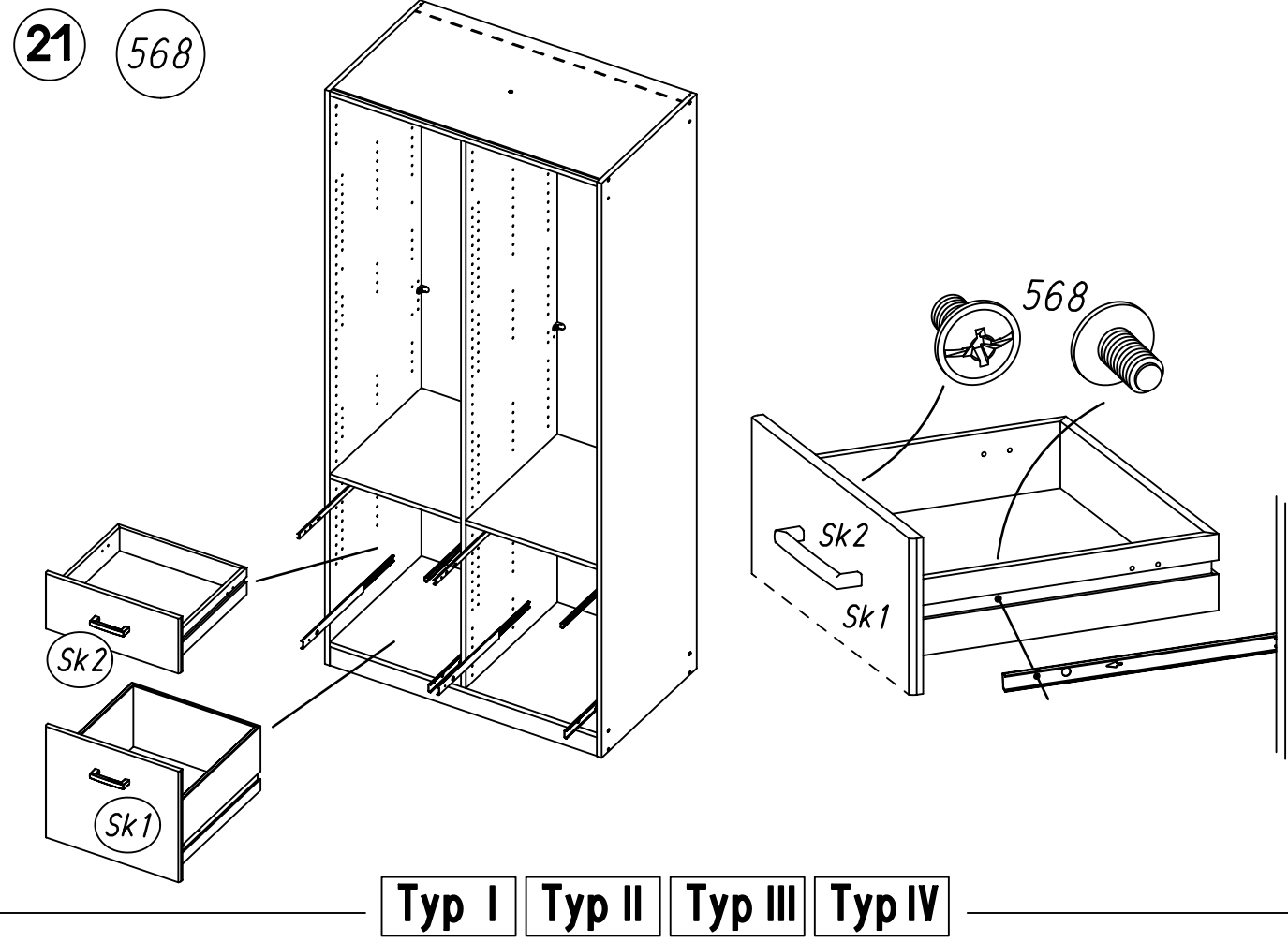

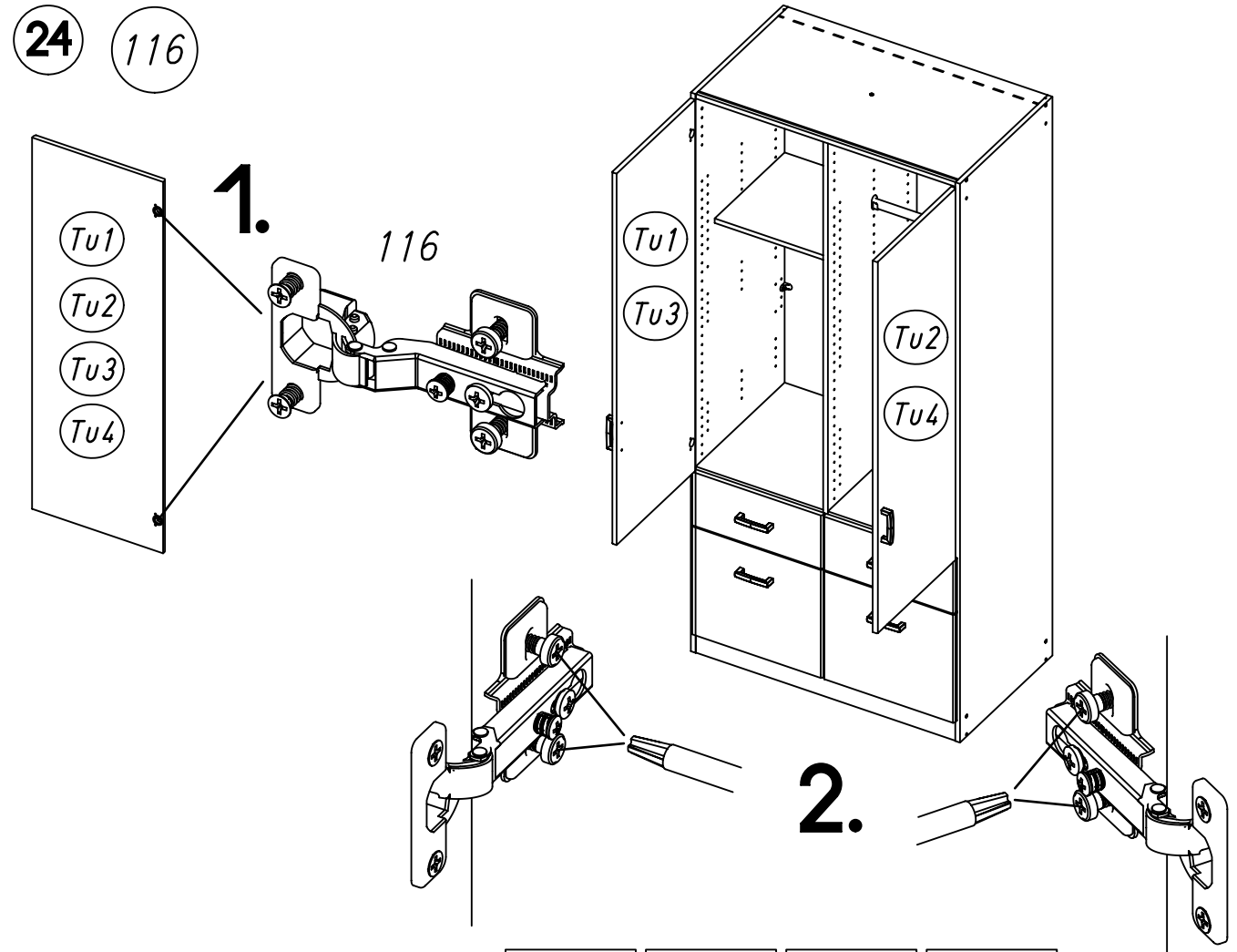

Typ I Typ II Typ III Typ IV

