

# AN4869B80305

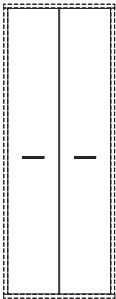

**A**

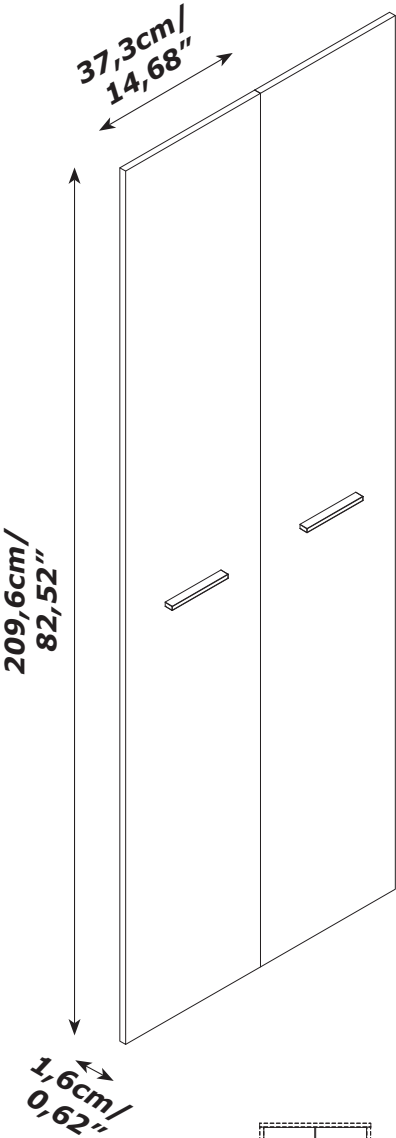
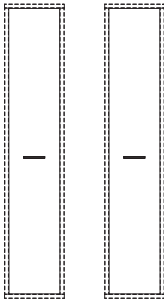

**B**

QF5962

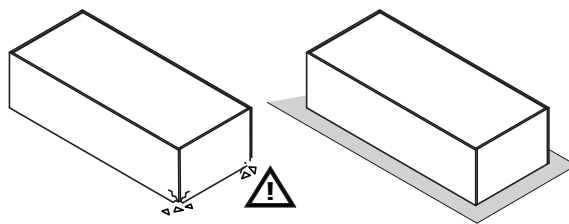
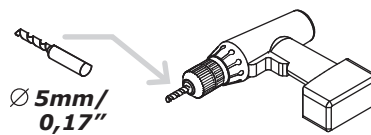
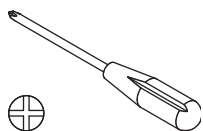
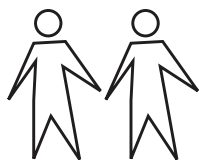

**BU4891**

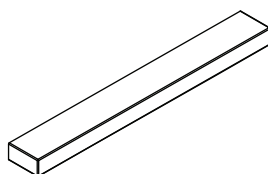

**M203**  
x2

**BU4892**



**H113**  
x10

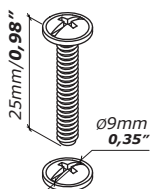

**V137**  
x4



**G171**  
x4

**BU3379 x2**

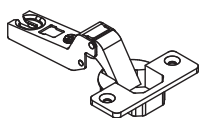

**C55**  
x8

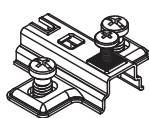

**B23**  
x8

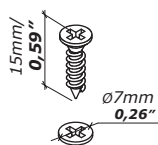

**V5**  
x16

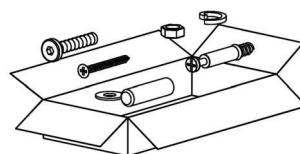
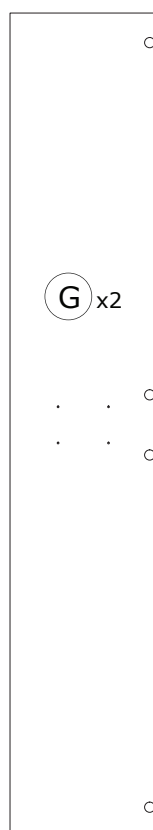
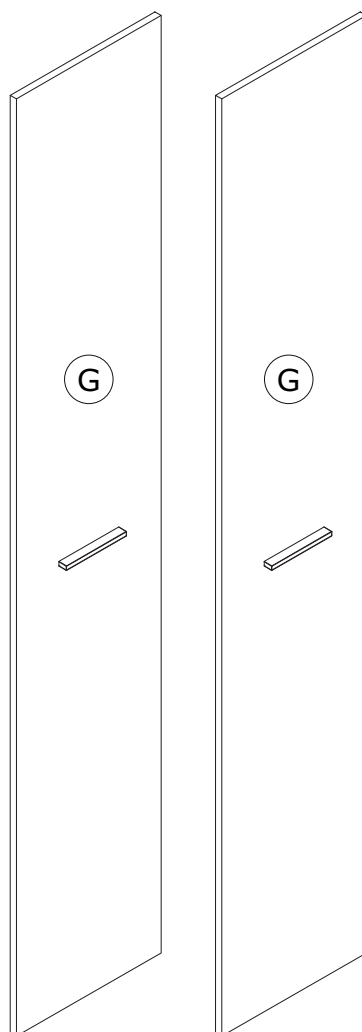

**AN3279**  
 2096x373x16mm/  
**82,52"x14,68"x0,63"**

1

A

B

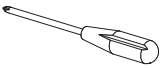

10x

H113  
h.2mm

16x

V5

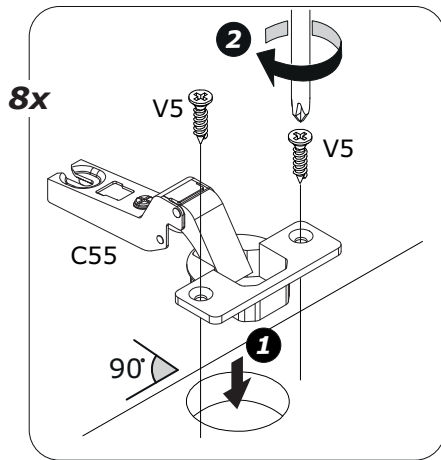

x2

G

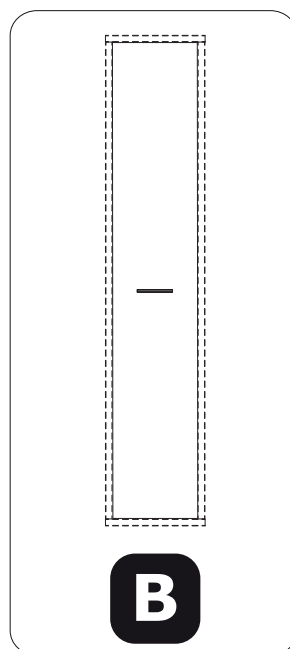
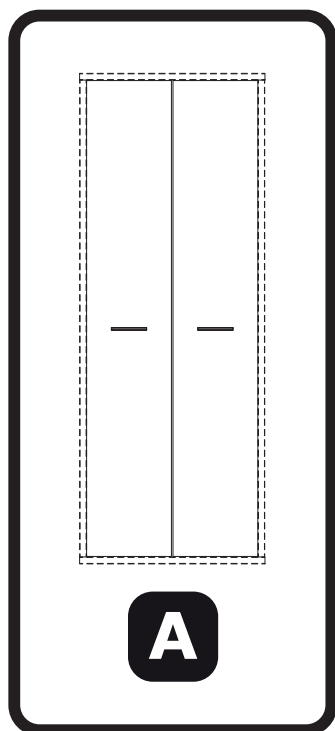
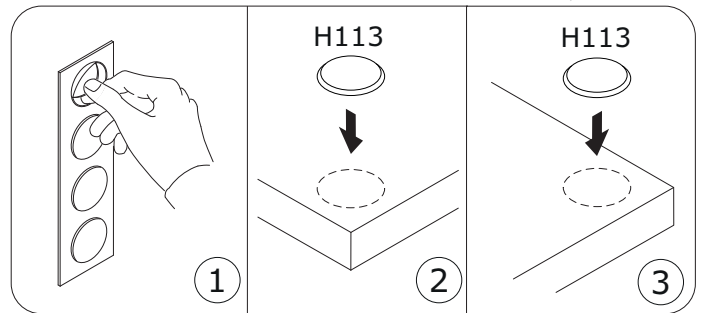

2

A

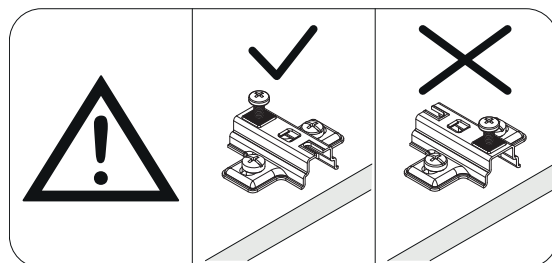
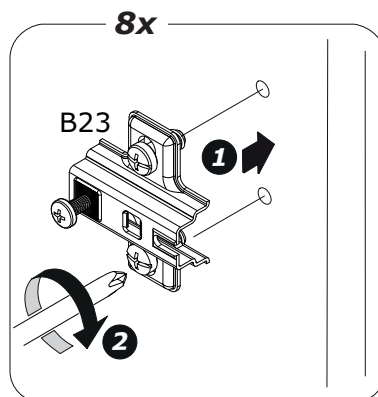
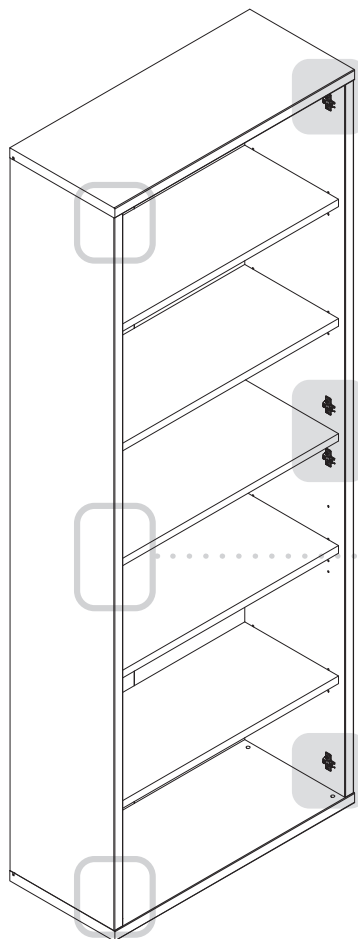

8x

C55

B23

1

C55

B23

2

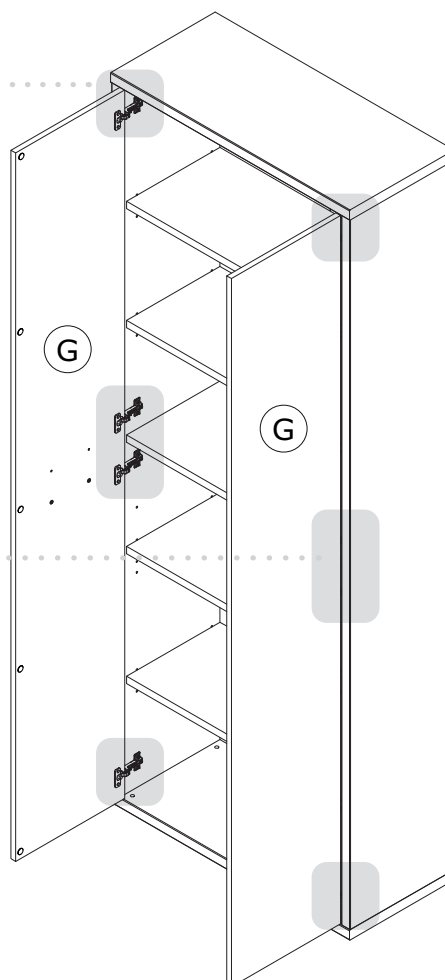

3

A

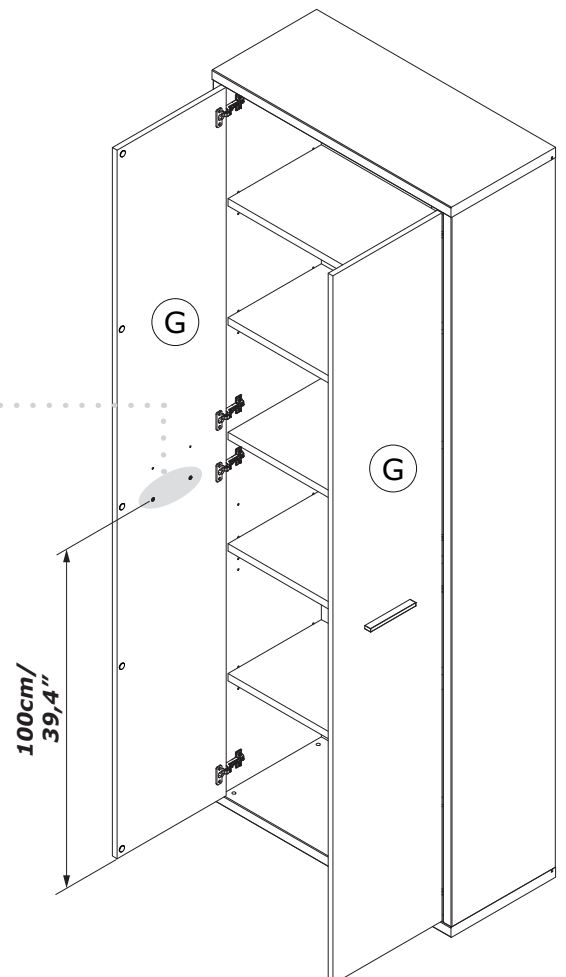
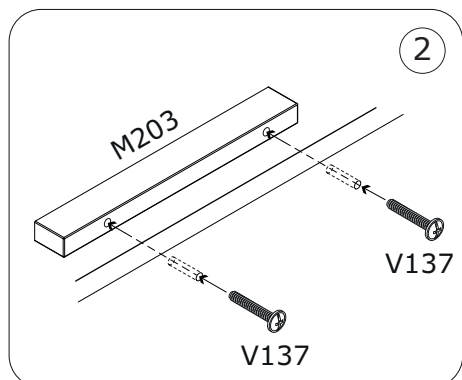
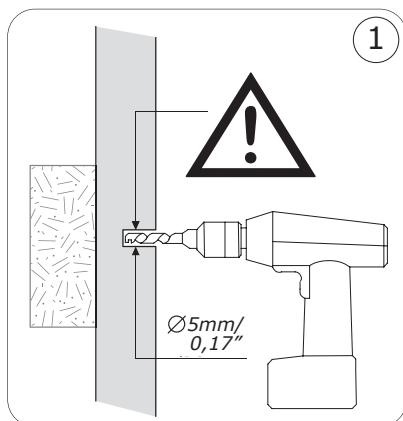
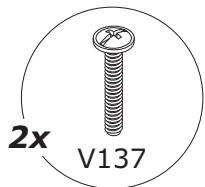
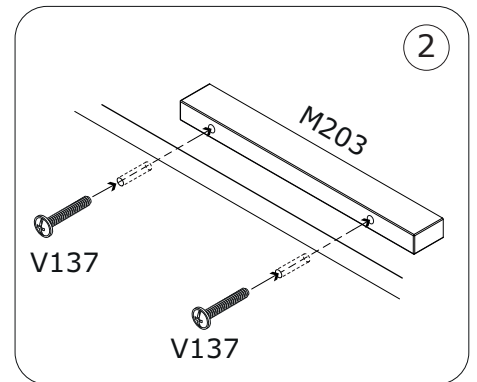
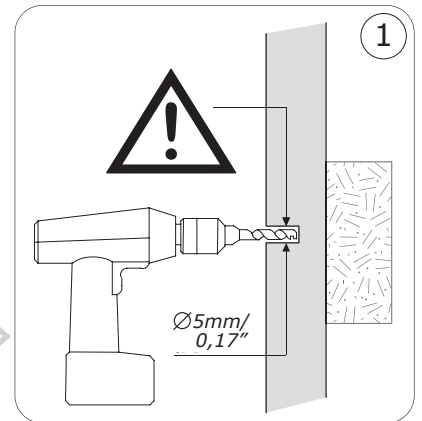
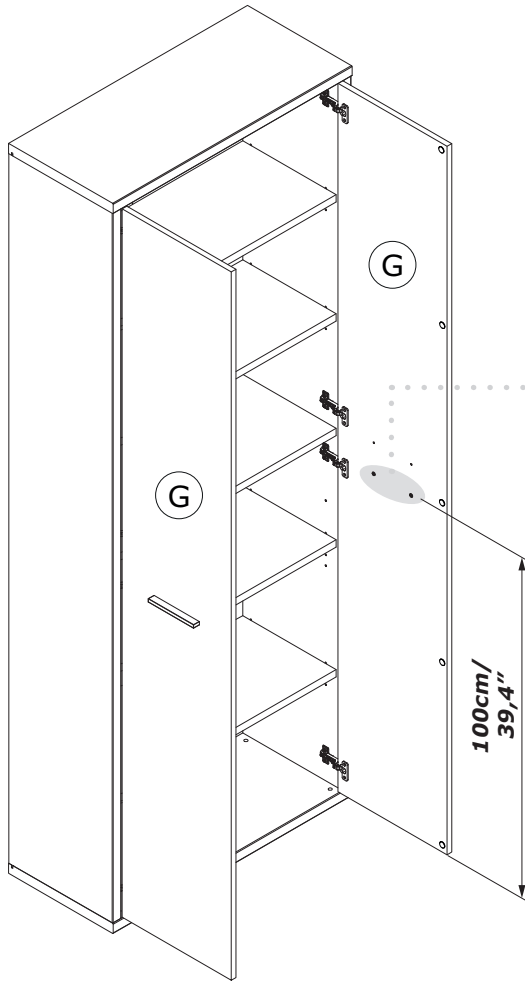
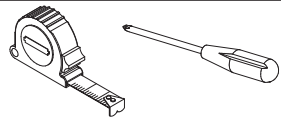

4

A

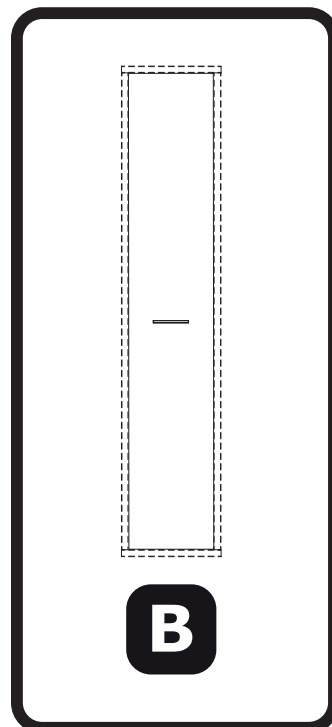
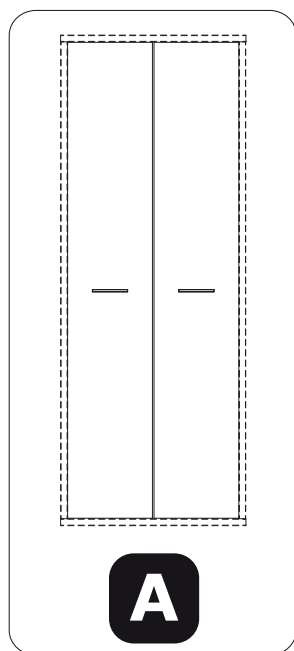
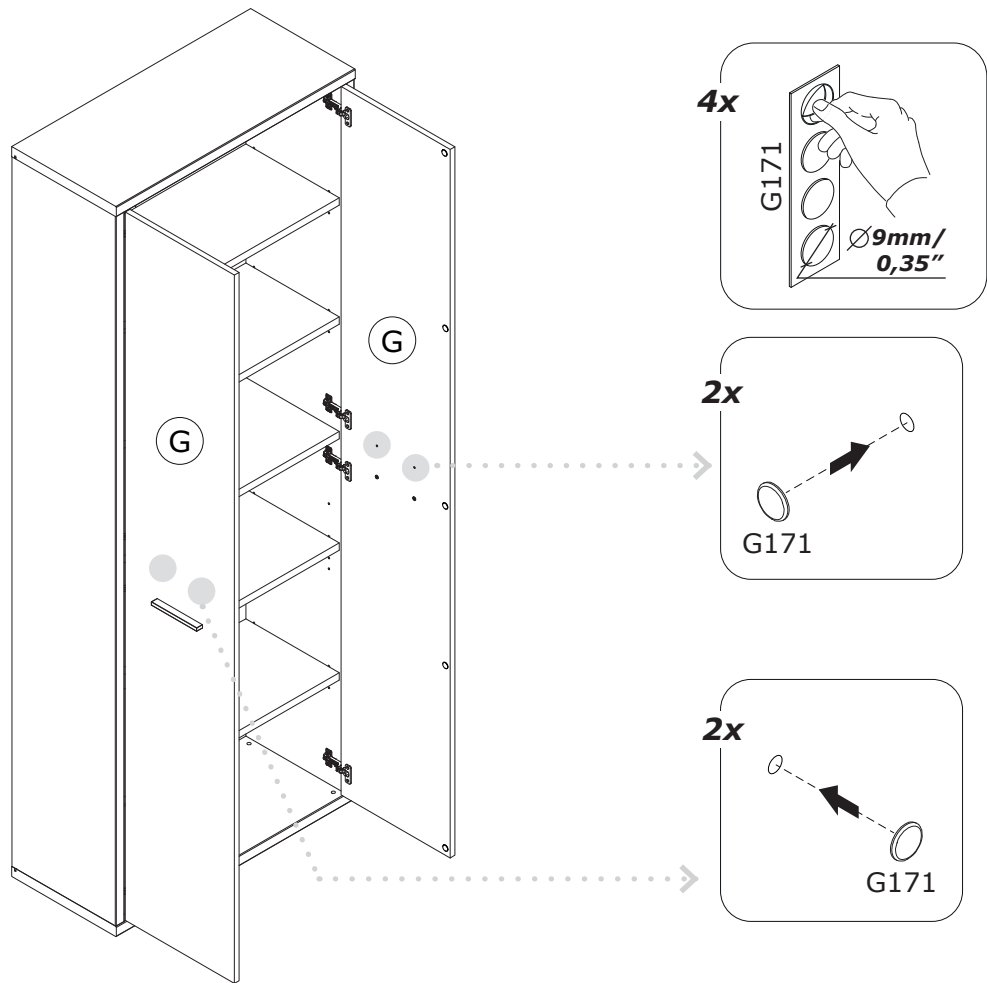

**B**

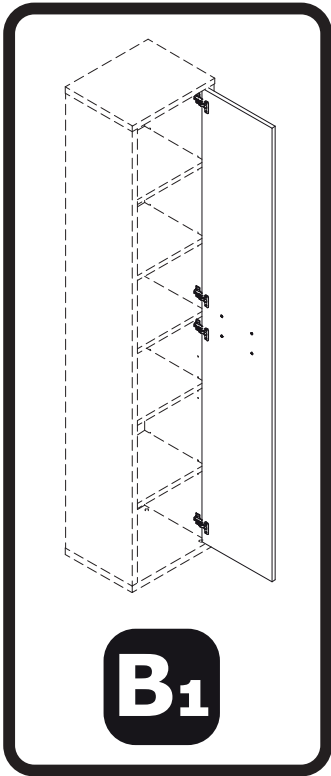

**B<sub>1</sub>**

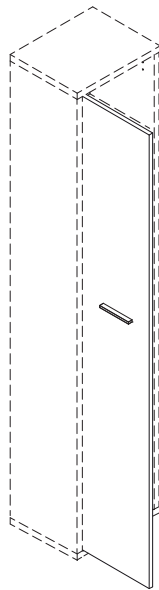

**B<sub>2</sub>**

**5**

**B<sub>1</sub>**

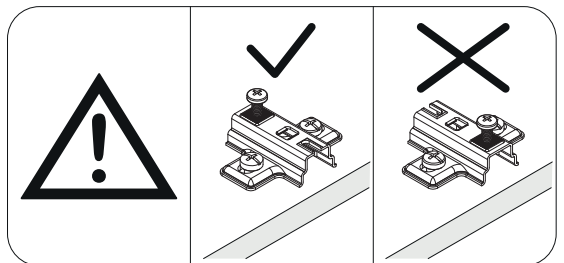
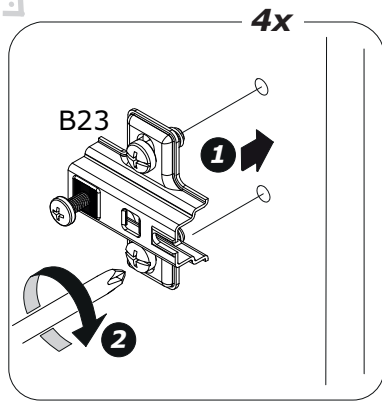
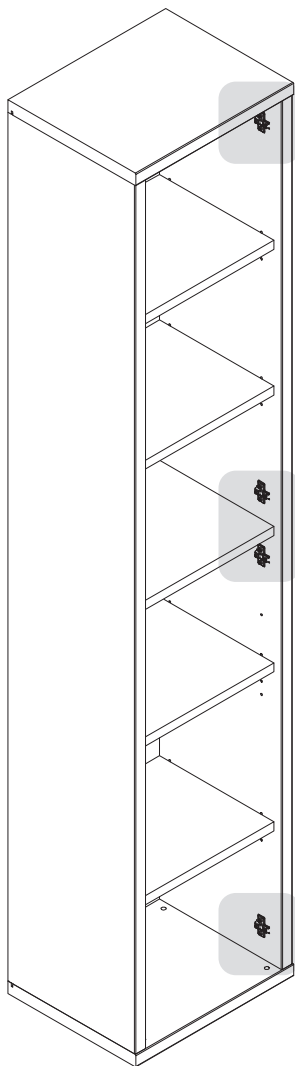
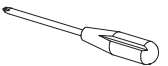

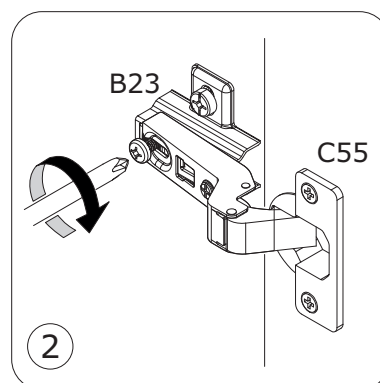
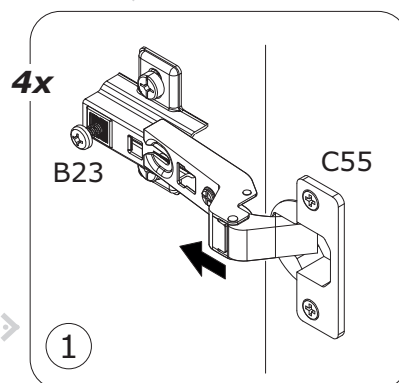
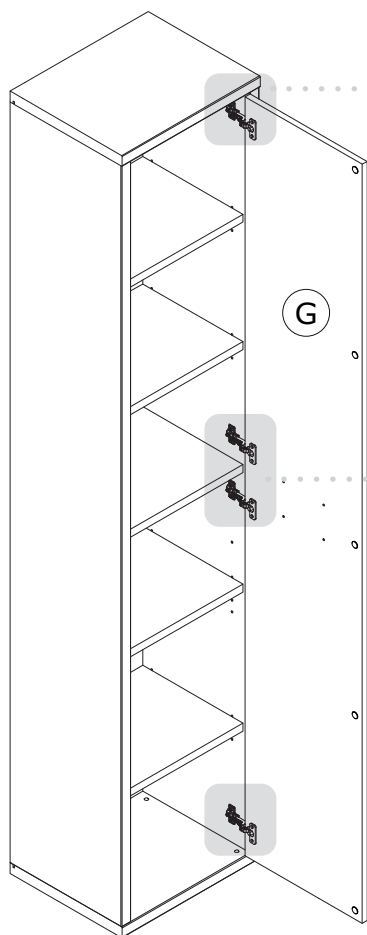

6

B<sub>1</sub>

7

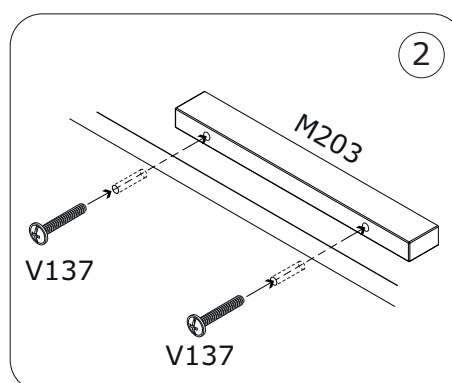
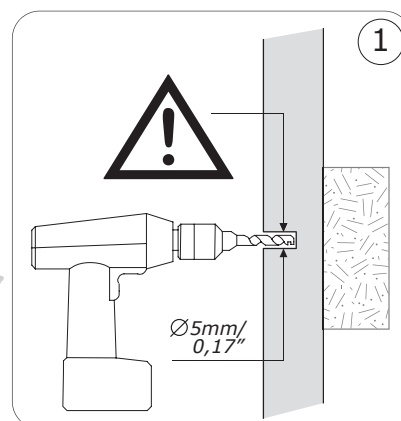
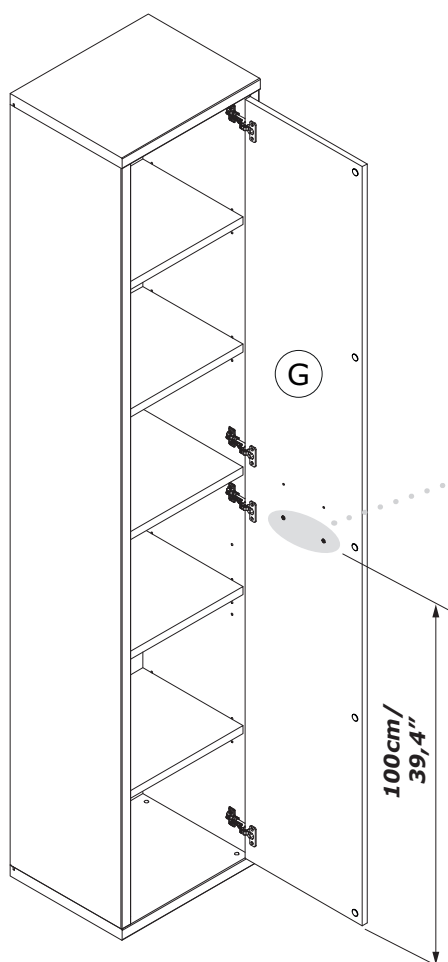
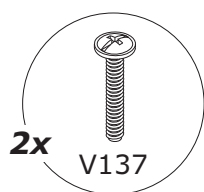
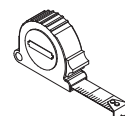
B<sub>1</sub>

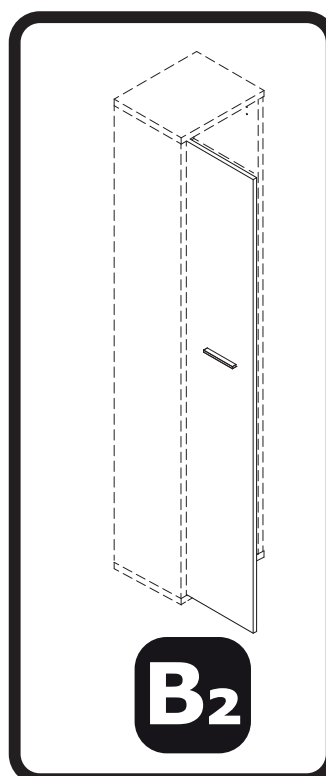
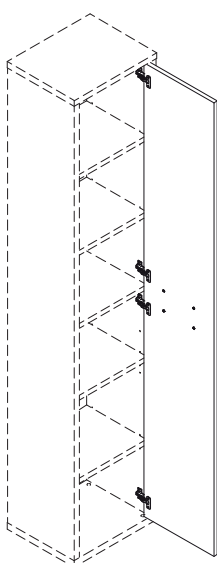
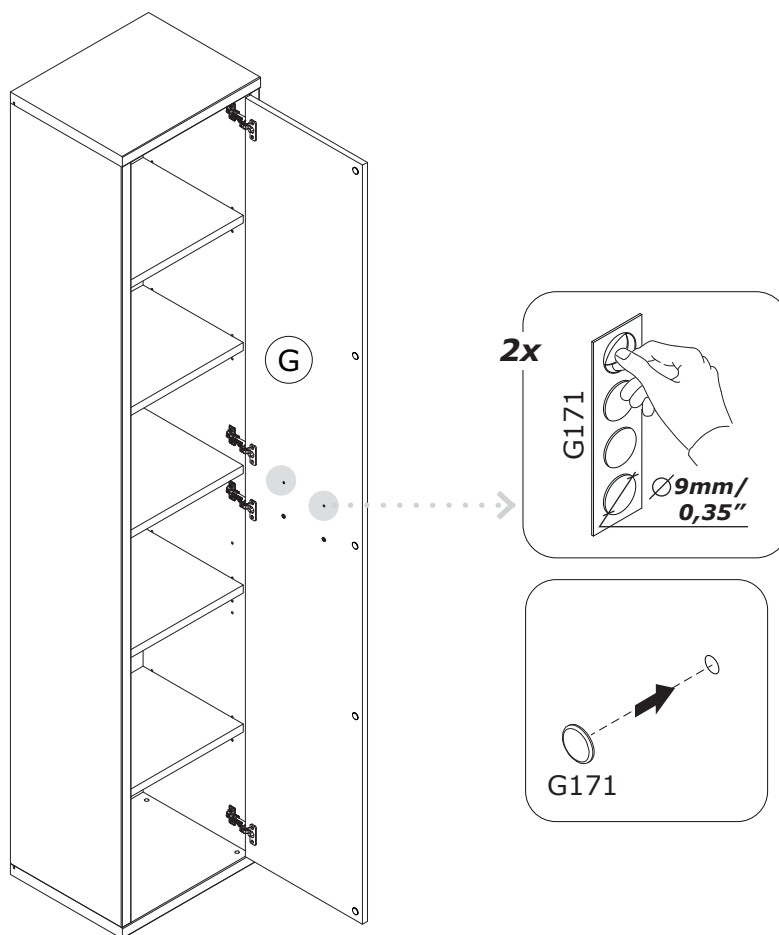

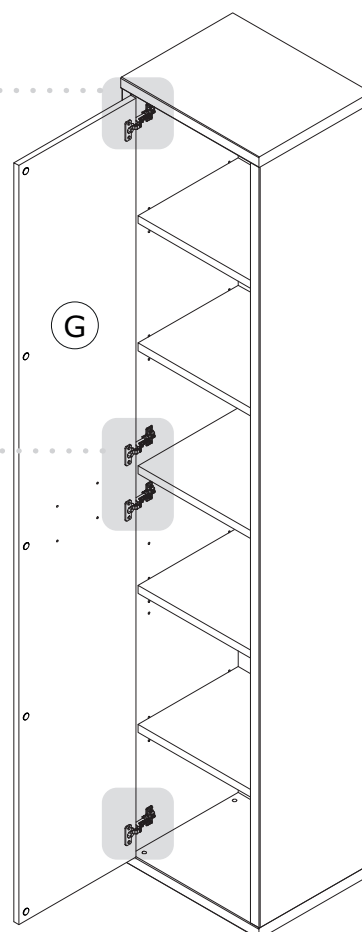
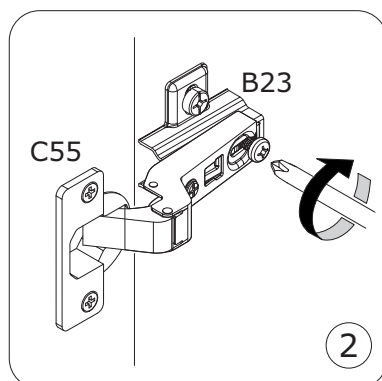
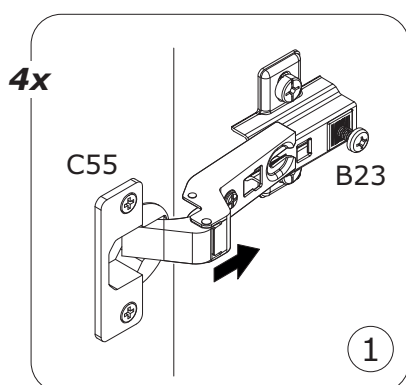
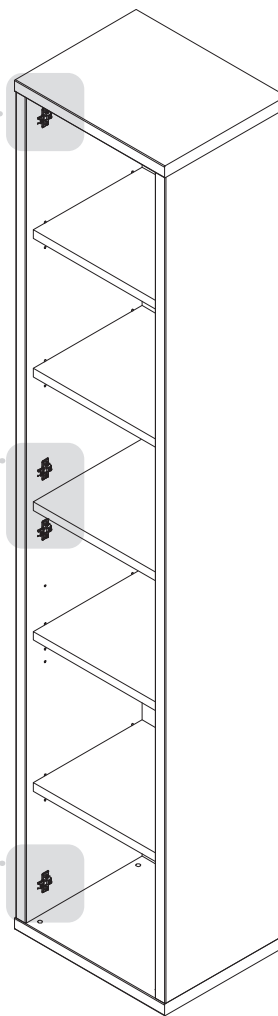
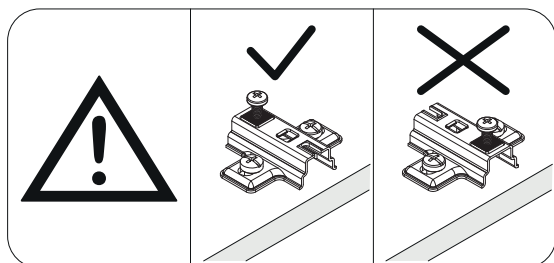
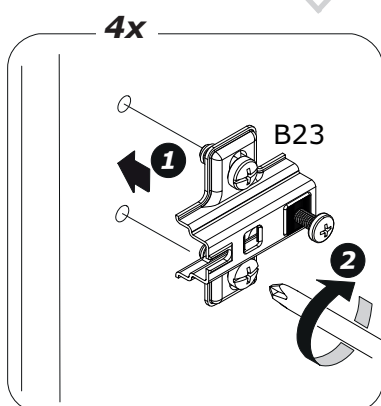

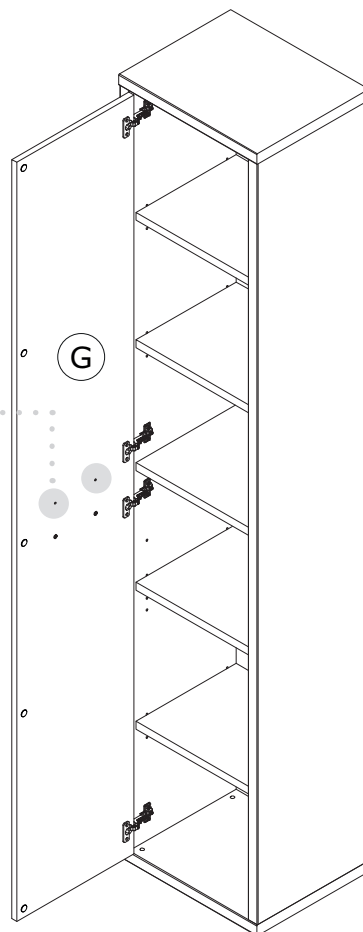
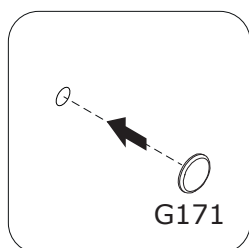
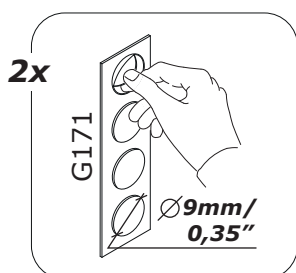
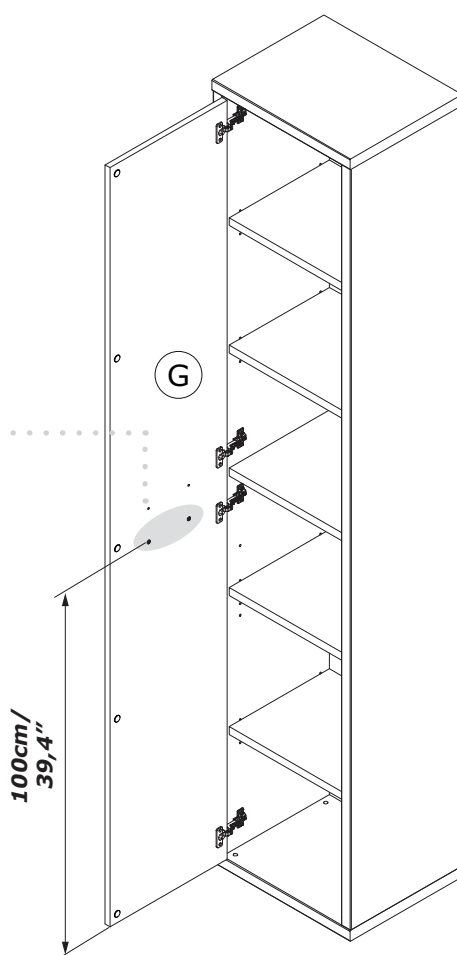
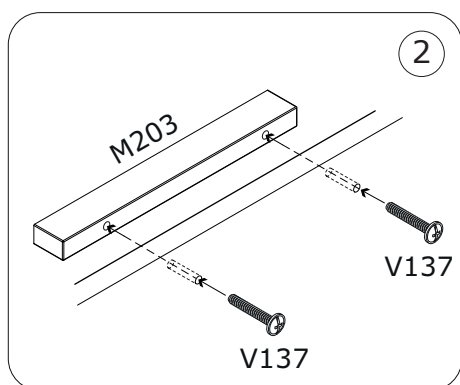
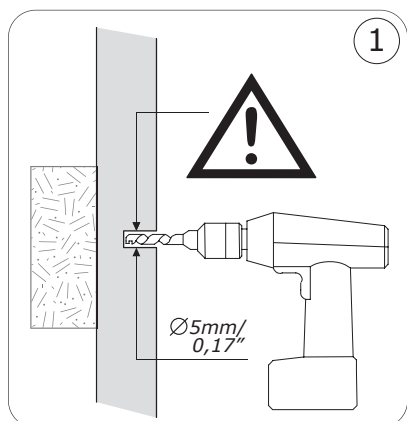
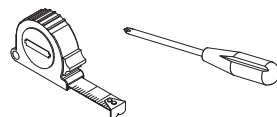

A

B

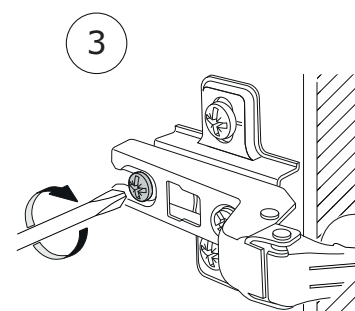
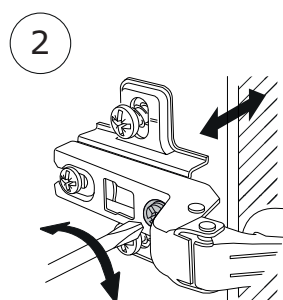
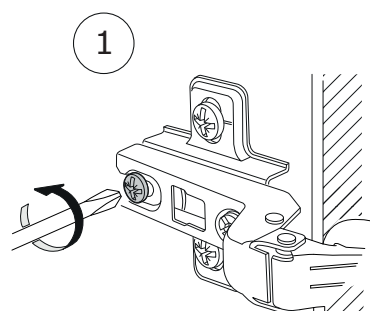
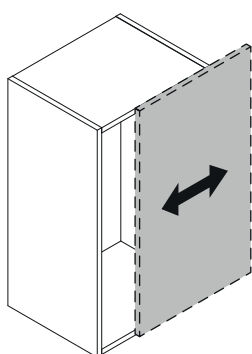
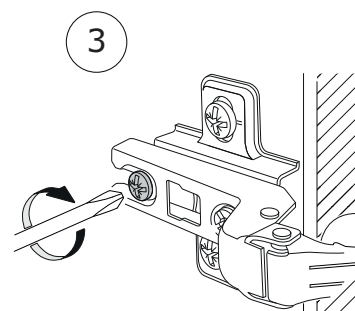
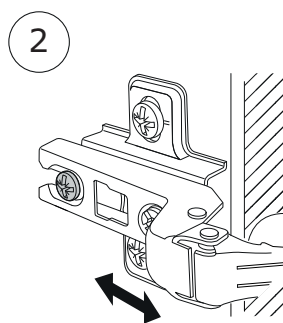
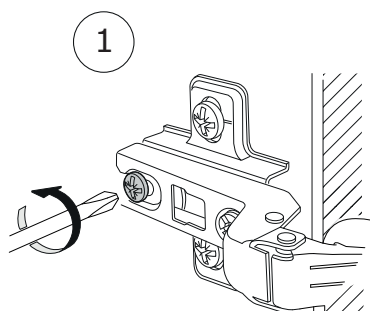
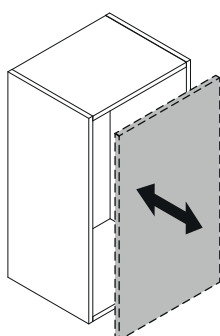
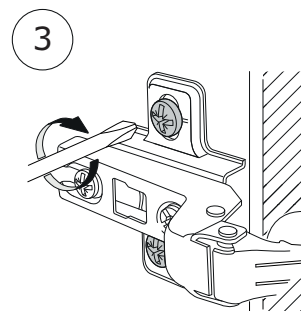
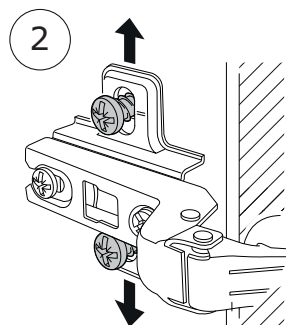
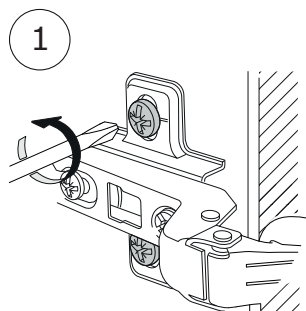
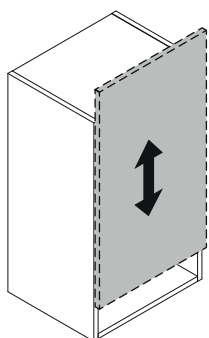

LB4801B80309



FSC  
www.fsc.org

MIX  
Wood from  
responsible sources  
FSC® C011298

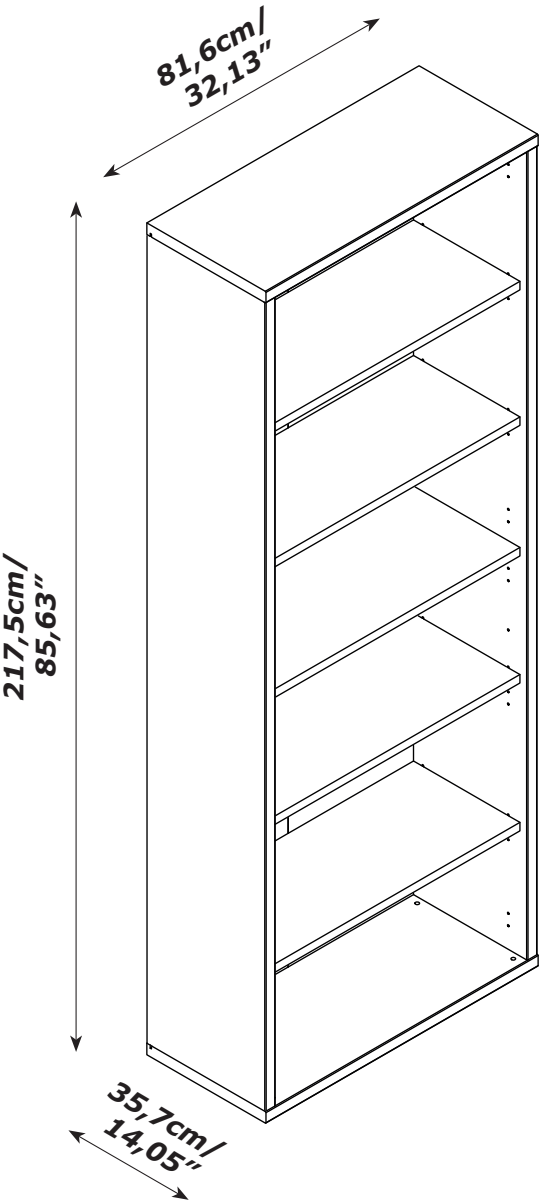

QF5809

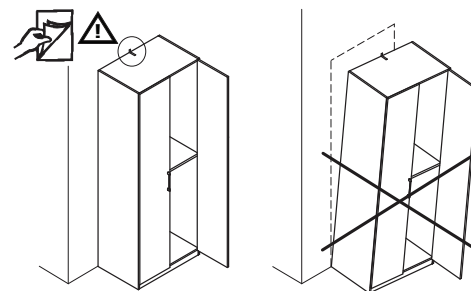
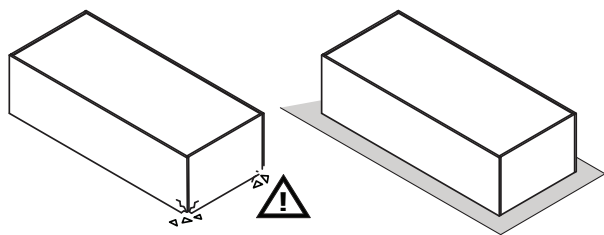
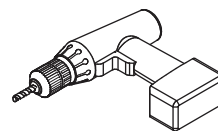
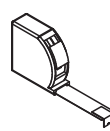
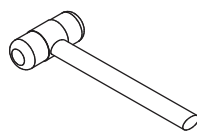
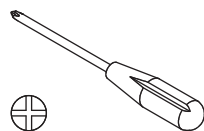
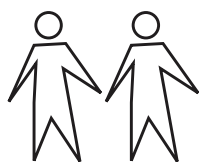

IT IS RECOMMENDED THAT THE ANTI-TIP KIT INCLUDED WITH THIS PRODUCT BE INSTALLED FOR ADDED SAFETY AND STABILITY.

IT IS ESSENTIAL TO USE WALL ANCHORS APPROPRIATE FOR YOUR WALL TYPE (I.E. PLASTER, DRY-WALL, CONCRETE, ETC.), ALONG WITH APPROPRIATE SCREWS, FOR PROPER MOUNTING. THE SCREWS INCLUDED IN THIS ANTI-TIP KIT MAY NOT BE SUITED FOR ALL WALL TYPES. MOUNTING TO WOOD STUDS IS RECOMMENDED.

CONSULT A QUALIFIED PROFESSIONAL OR YOUR LOCAL HARDWARE STORE FOR APPROPRIATE MOUNTING HARDWARE SUITED FOR YOUR SPECIFIC WALL MEDIUM.

## BU4885

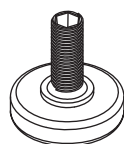

**P25**  
x4



**H118**  
x4

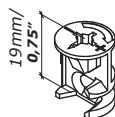

**T97**  
x4

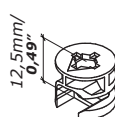

**T7**  
x4

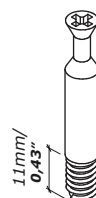

**T28**  
x8

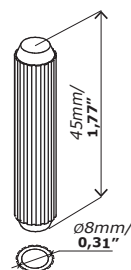

**H325**  
x12

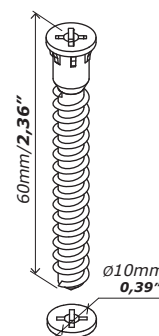

**V57**  
x4



**R40**  
x16



**H2**  
x20

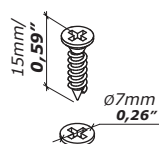

**V5**  
x20

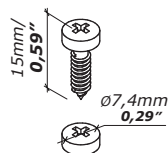

**V81**  
x2



**G171**  
x22



**G198**  
x4



**G199**  
x4

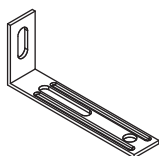

**H185**  
x1



**H129**  
x2

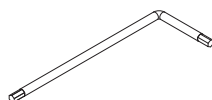

**H138**  
x1

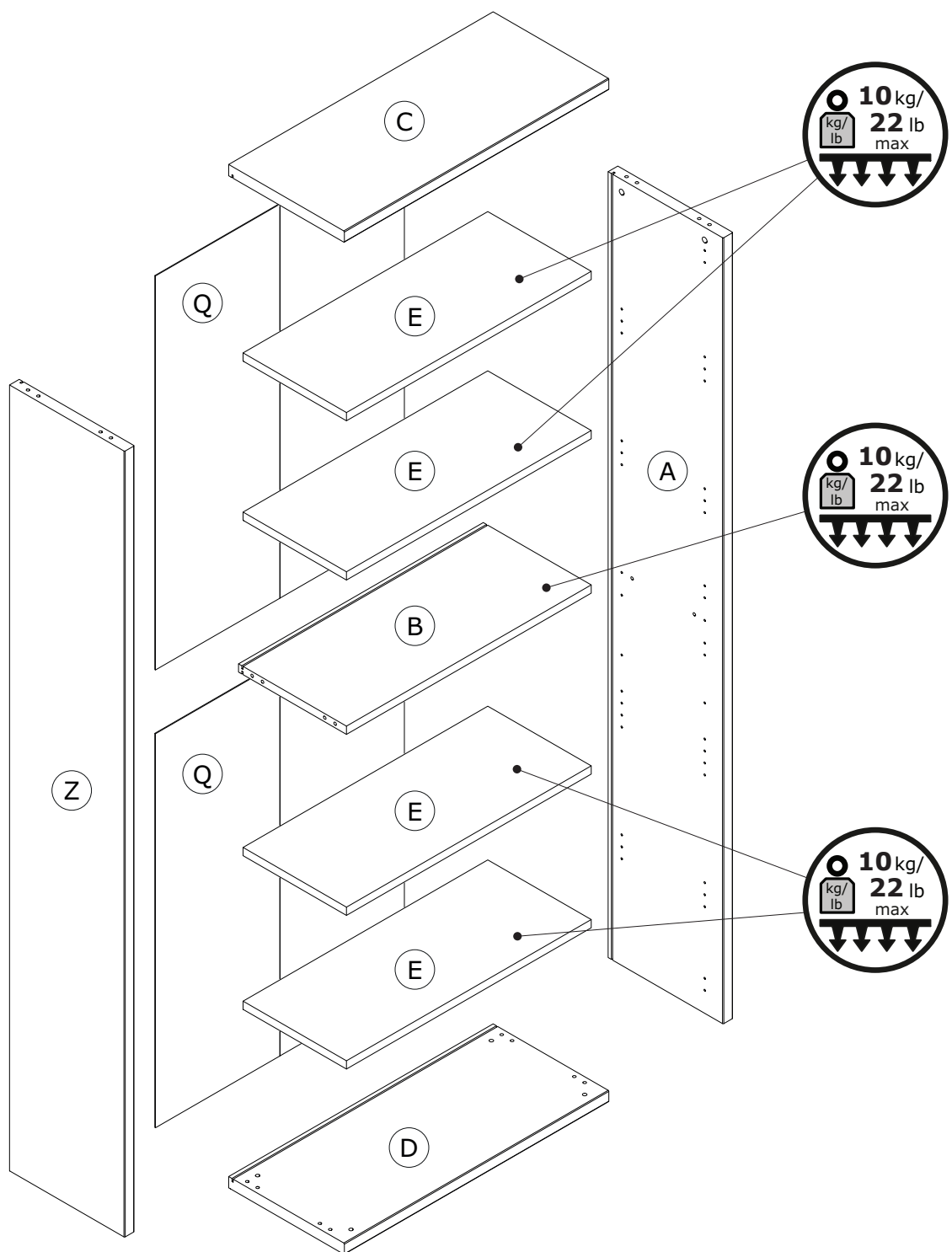



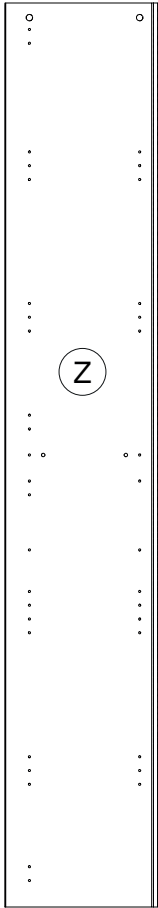

**FI9312**  
2100x355x30mm/  
**82,68"x13,98"x1,18"**

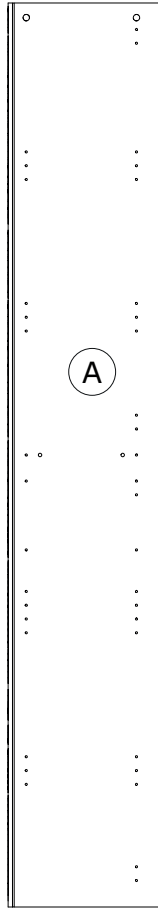

**FI9313**  
2100x355x30mm/  
**82,68"x13,98"x1,18"**

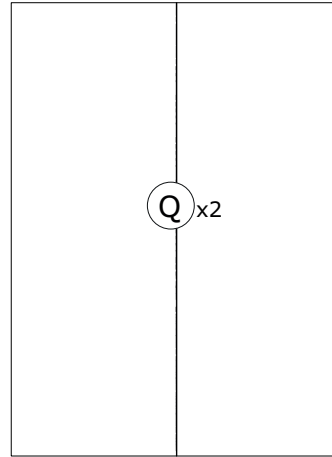

**SH3790**  
1053x768x2mm/  
**41,45"x30,23"x0,079"**

**BOX 1/2**

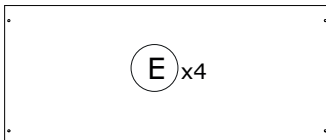

**PI7561**  
755x319x22mm/  
**29,72"x12,56"x0,87"**

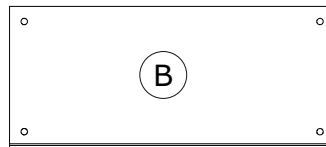

**PI7562**  
755x319x22mm/  
**29,72"x12,56"x0,87"**

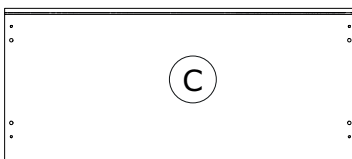

**CA3905**  
816x357x30mm/  
**32,13"x14,05"x1,18"**

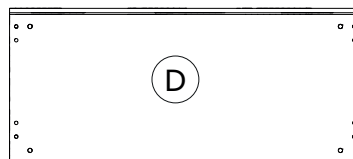

**BA2398**  
816x357x30mm/  
**32,13"x14,05"x1,18"**

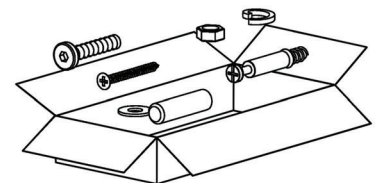

**BOX 2/2**

1

8x

H325

A

Z

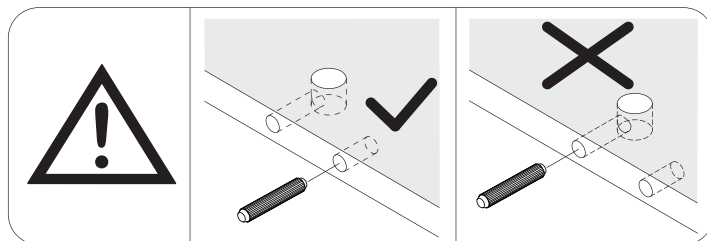

2

4x

T28

A

Z

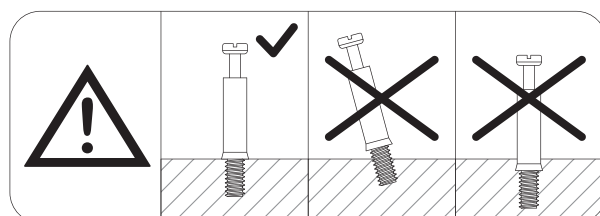

3

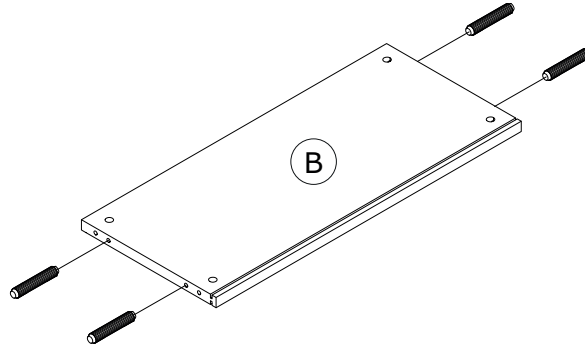
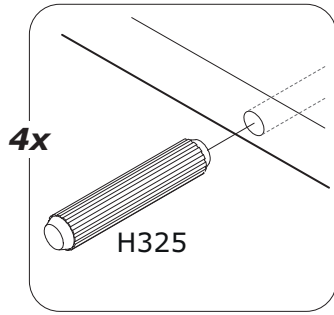
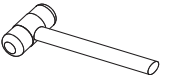

4

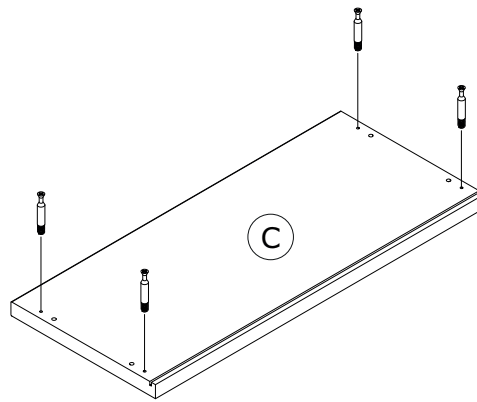
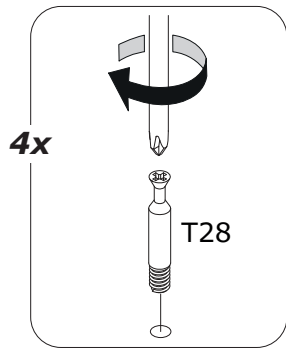
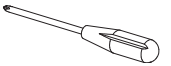

5

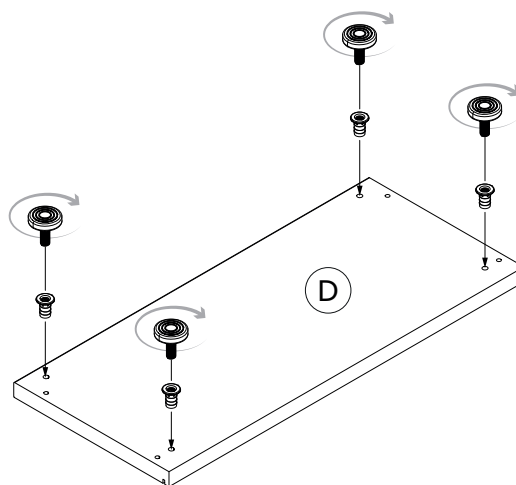
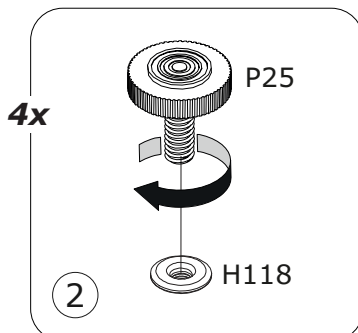
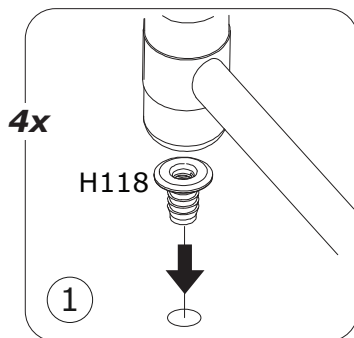
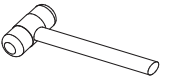

6

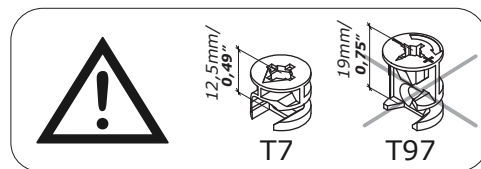
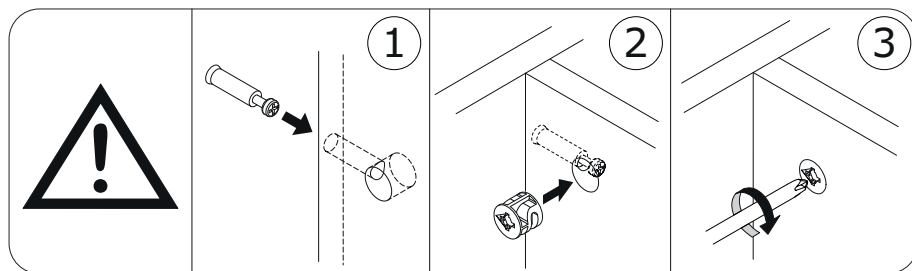
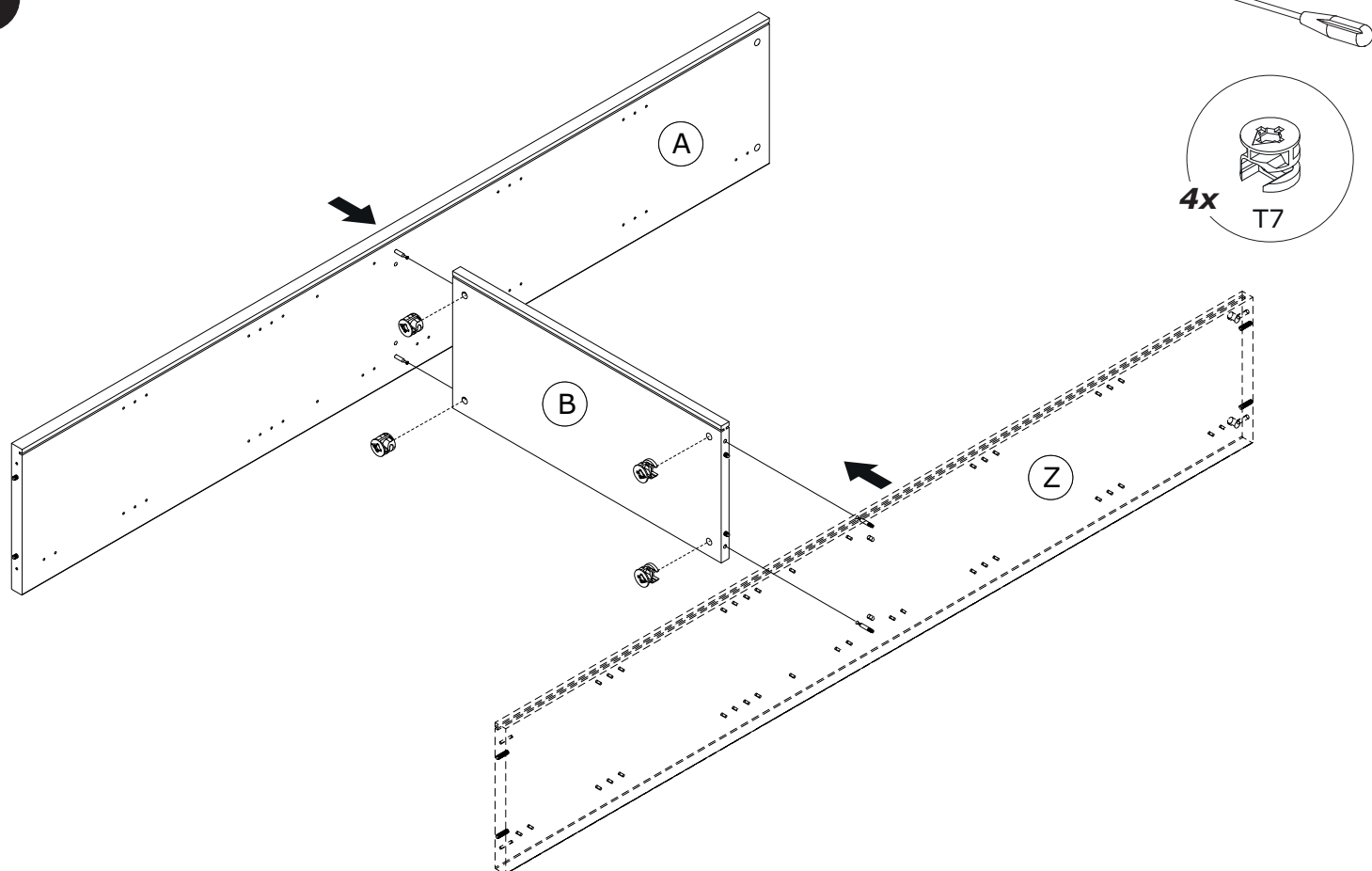

7

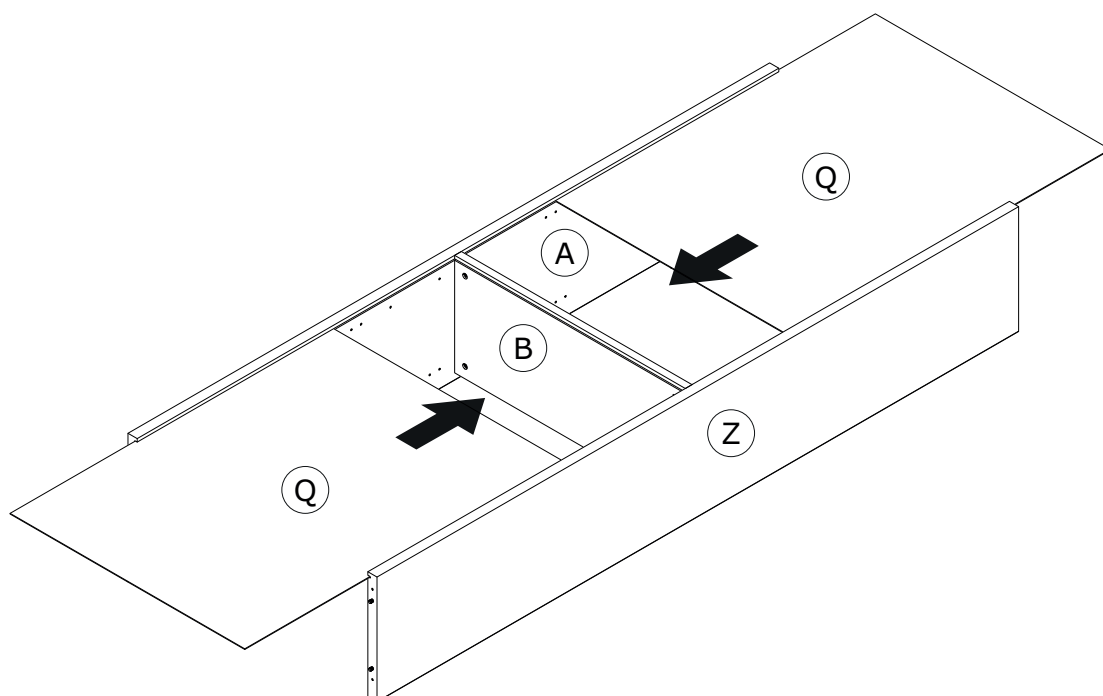

8

4x

V57

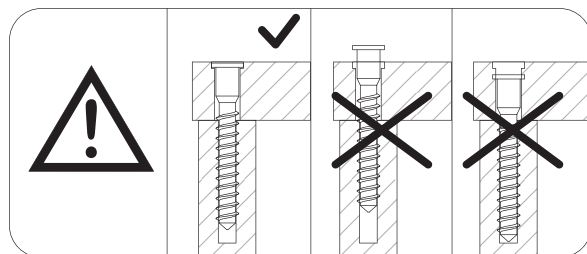
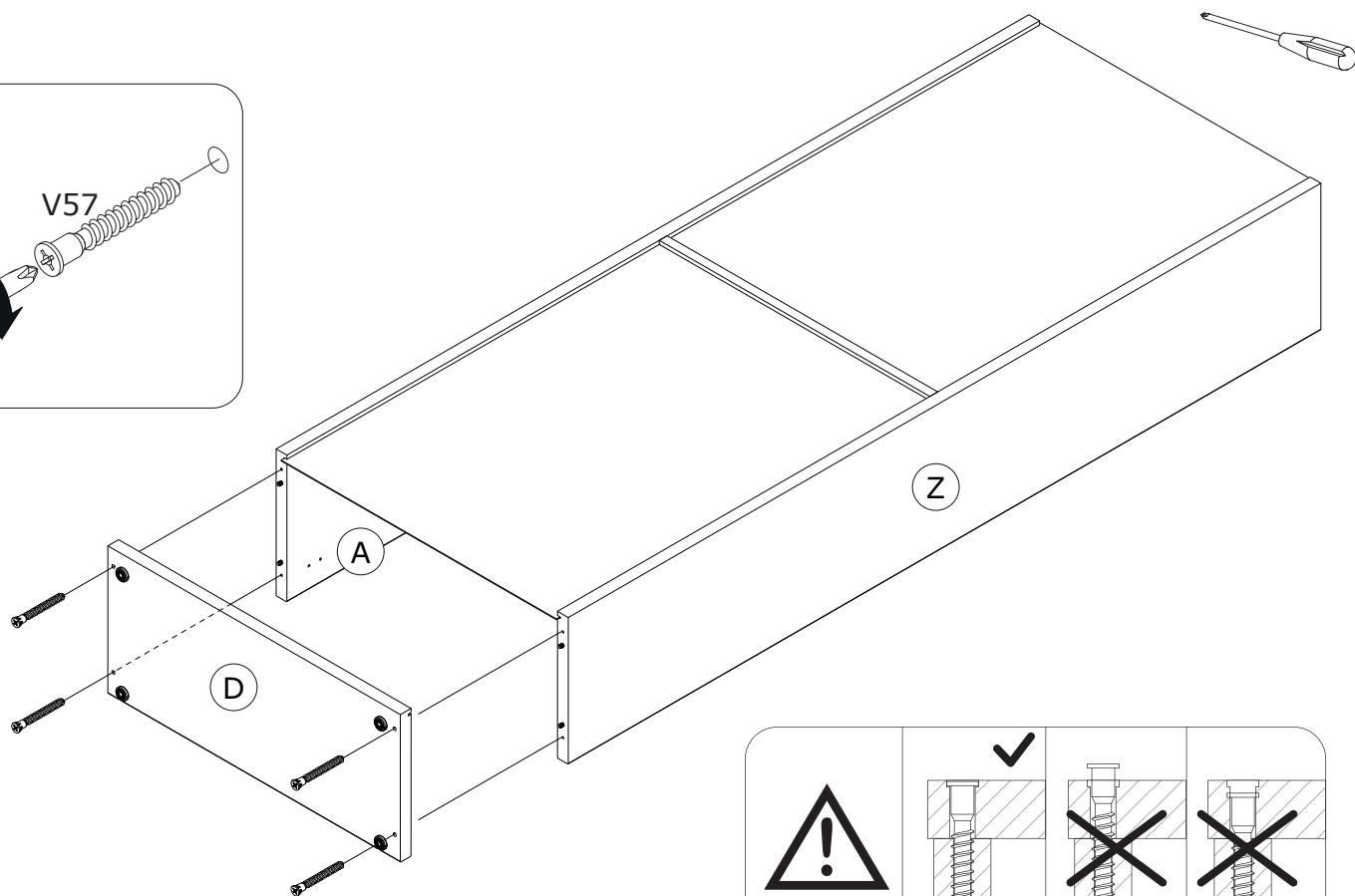

9

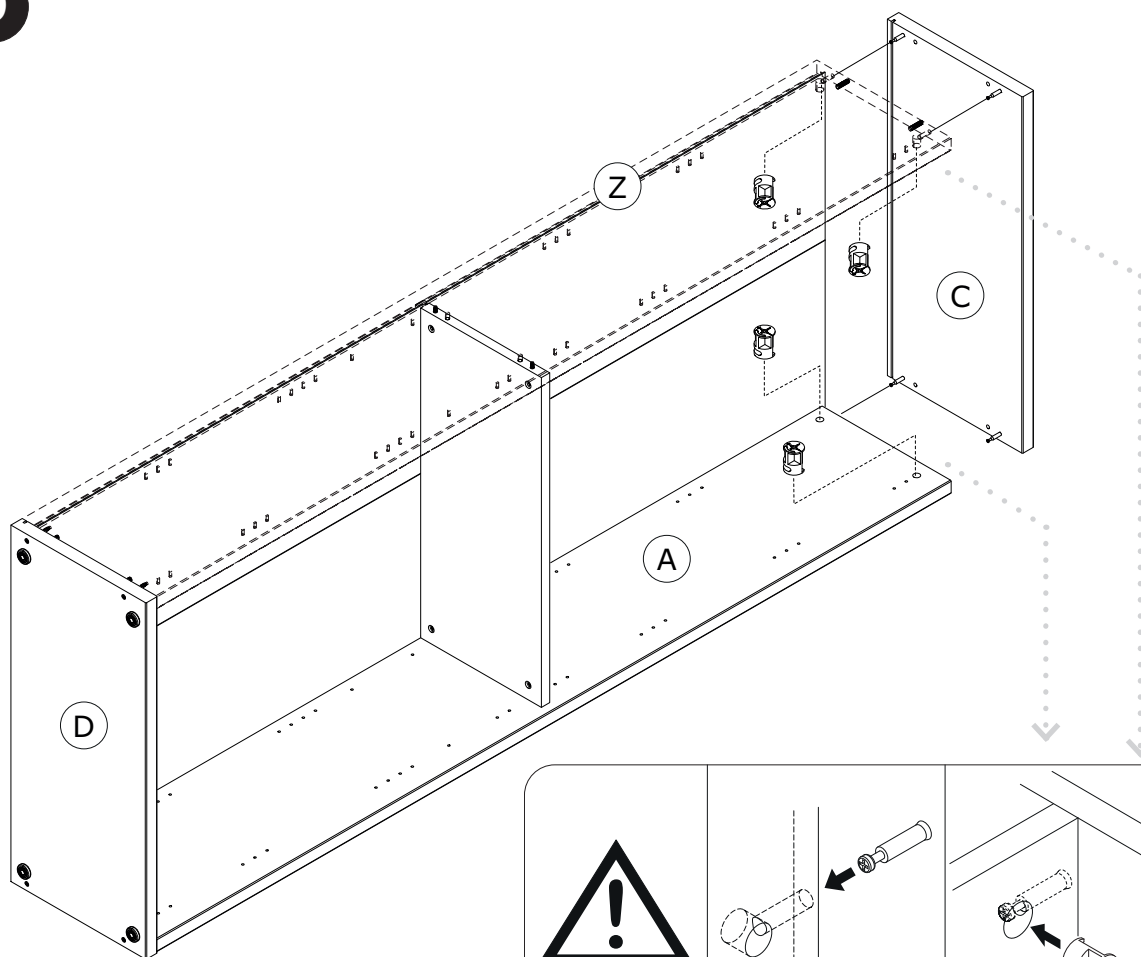

4x

T97

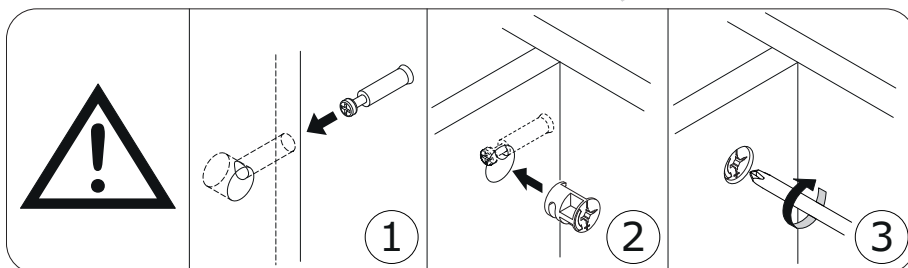

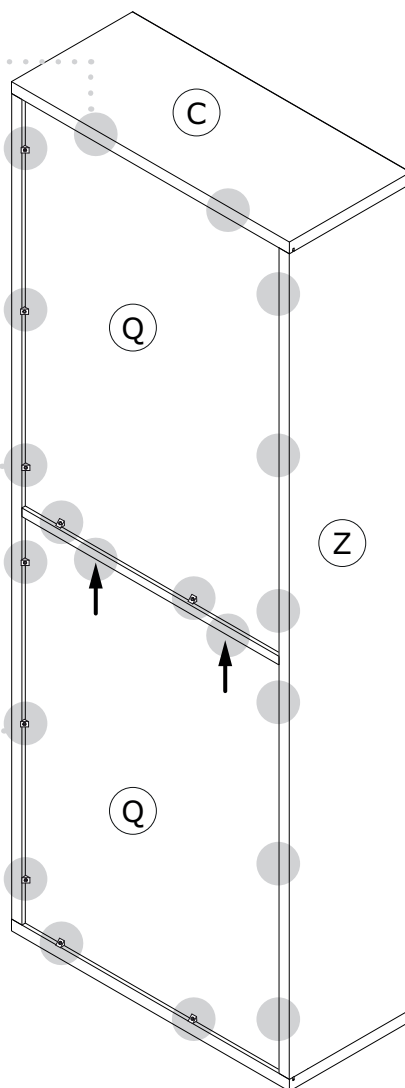
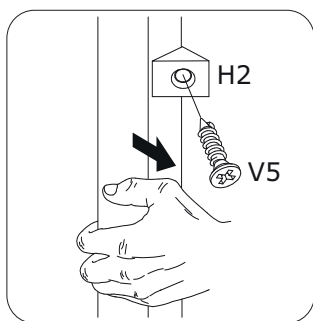
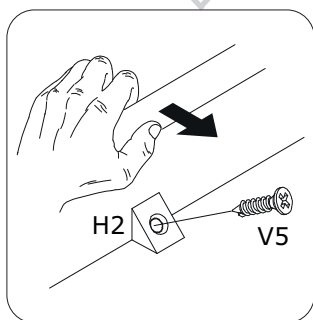

20x

H2

20x

V5

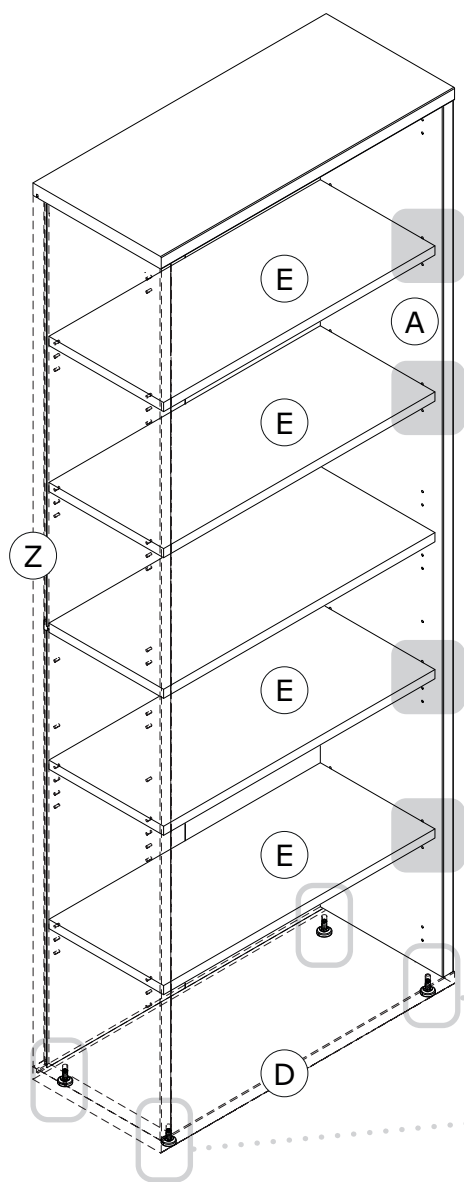

16x

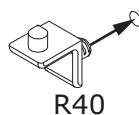

1

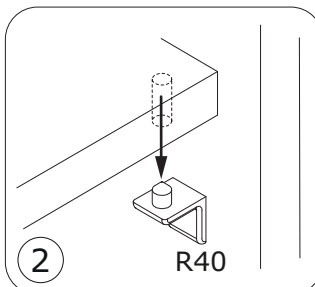

2

R40

4x

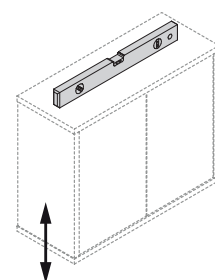

1

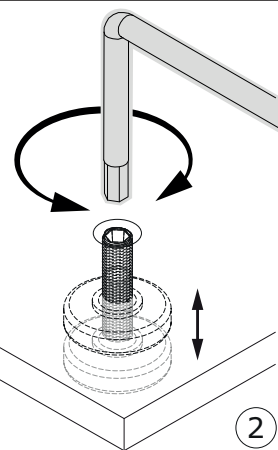

2

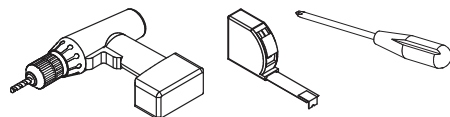

IT IS RECOMMENDED THAT THE ANTI-TIP KIT INCLUDED WITH THIS PRODUCT BE INSTALLED FOR ADDED SAFETY AND STABILITY.

IT IS ESSENTIAL TO USE WALL ANCHORS APPROPRIATE FOR YOUR WALL TYPE (I.E. PLASTER, DRY-WALL, CONCRETE, ETC.), ALONG WITH APPROPRIATE SCREWS, FOR PROPER MOUNTING.

THE SCREWS INCLUDED IN THIS ANTI-TIP KIT MAY NOT BE SUITED FOR ALL WALL TYPES.

MOUNTING TO WOOD STUDS IS RECOMMENDED.

CONSULT A QUALIFIED PROFESSIONAL OR YOUR LOCAL HARDWARE STORE FOR APPROPRIATE MOUNTING HARDWARE SUITED FOR YOUR SPECIFIC WALL MEDIUM.

