

REPC-Nr.:

Service • Assistenza • Dienstverlening • Serwis
Servis • Szerviz • Сервисная служба

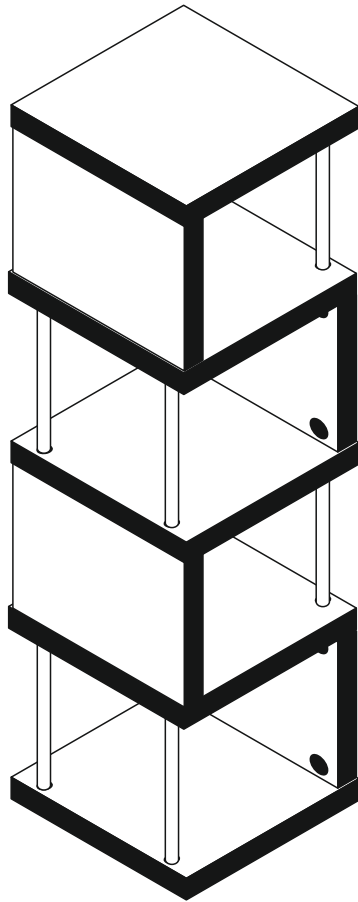

Artikel.-Nr.:

0511_00

Montageanleitung.-Nr.:

MA1-00172

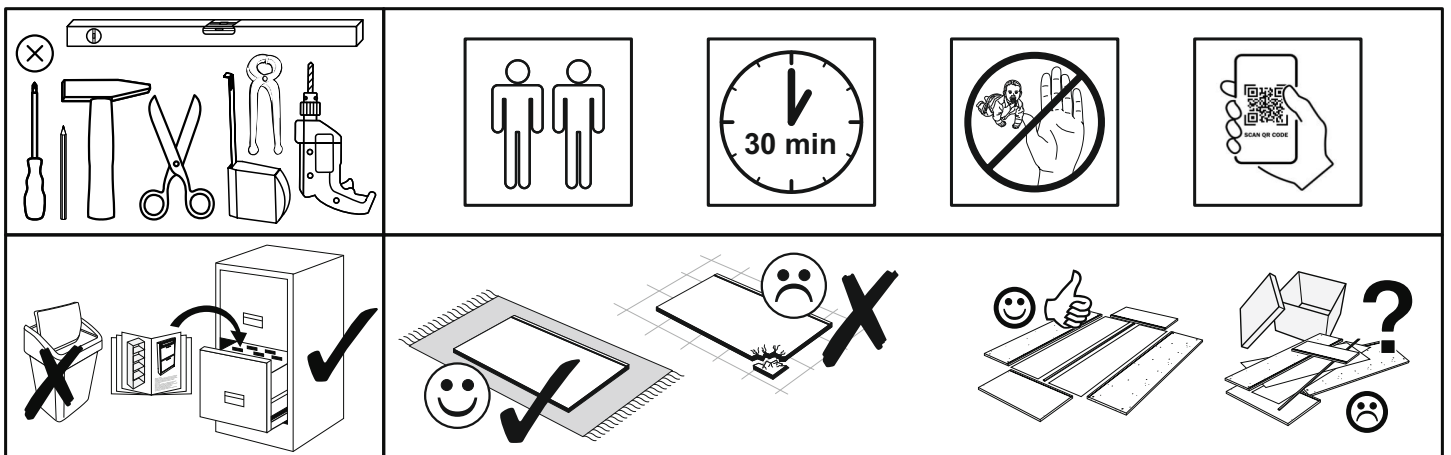

SCAN ME

Das Ersatzteil-Anforderungsformular finden Sie auf
The replacement parts requisition form you find on
<https://www.maeusbacher.de/ersatzteile/>

Beutel 0511-0512/00 B1

B01-90		B02-10		B02-20		B02-170		B05-130	
4x	3,5x20	16x	h=12mm	16x		4x		2x	



▶ SCAN ME

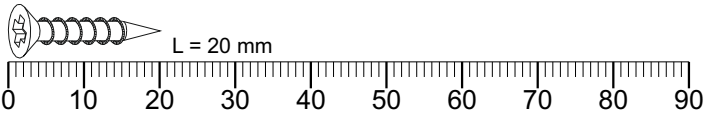

Colli 1/1



FTx-000650

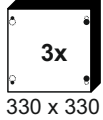

FTx-000652

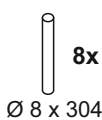

Z12-304

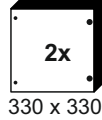

FTx-000651

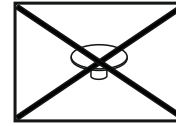

Artikel enthält keine Abdeckkappen für Excenter (Teil B02-10)!

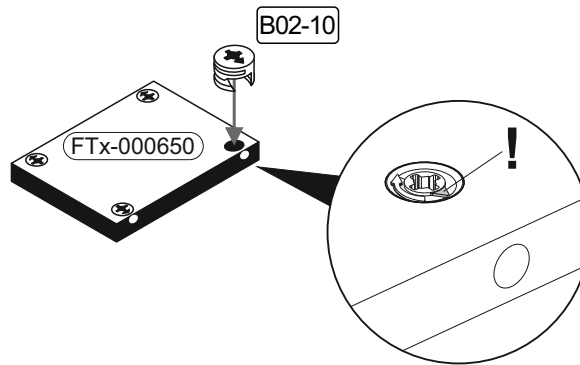
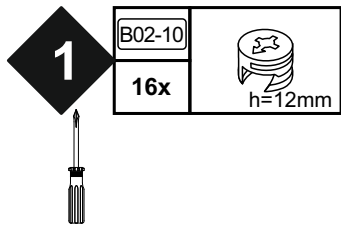

B01-90		B02-20		B02-170		B05-130	
4x	3,5x20	16x		4x		2x	

