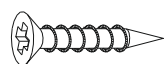
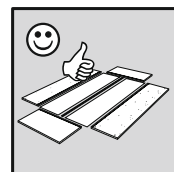
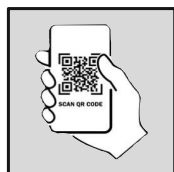
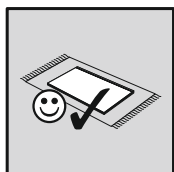
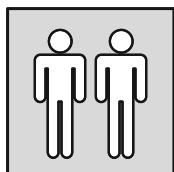
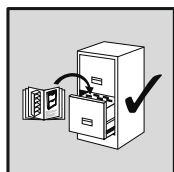

Artikel.-Nr.:

8001-FS-4er

Montageanleitung.-Nr.:

MA1-00527

L = 20 mm



Das Ersatzteil-Anforderungsformular finden Sie auf
The replacement parts requisition form you find on
<https://www.maeusbacher.de/ersatzteile/>



Colli 1/1



Beutel	
B01-33	
32x	4,0x17

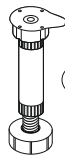

Z03-100
2x

136-170mm

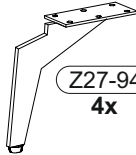

Z27-94
4x

150mm

Boden ohne Mittelseite

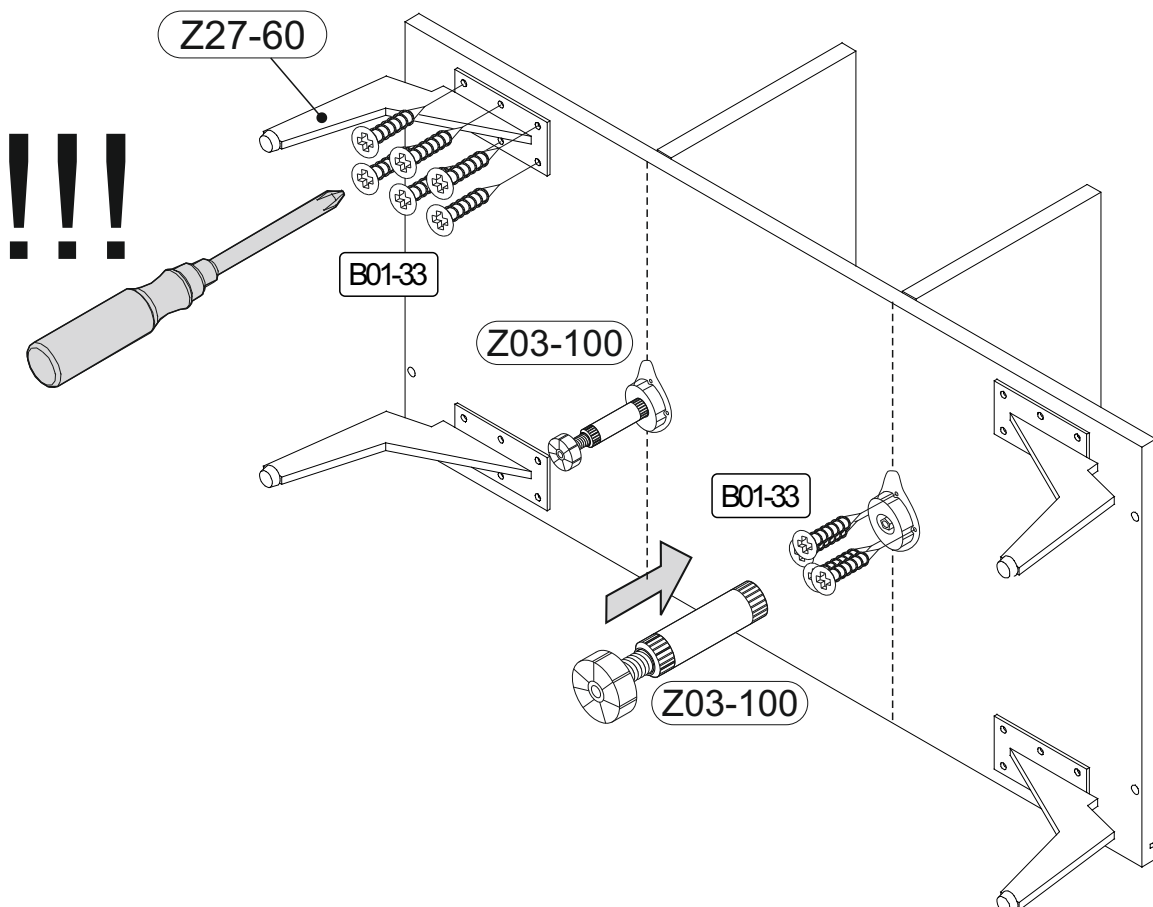
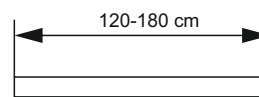
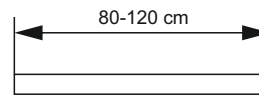
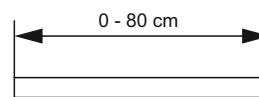

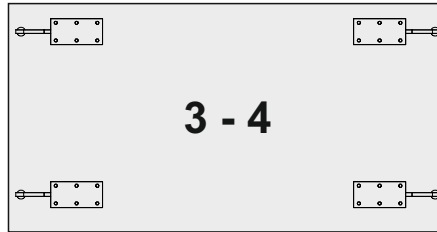

Schablone zum Auflegen auf den Boden

(hierzu die Ecken (**L=links weiß**) + (**R=rechts grau**) des Blattes mit den Kanten des Bodens bündig legen und mit einem Dorn die Löcher vorstechen.)

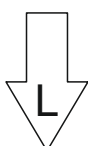
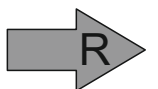
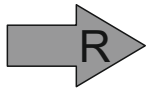
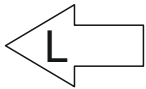

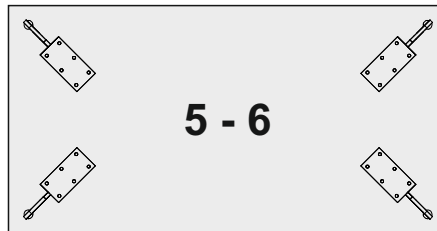

Colli 1/1



Beutel	
B01-33	
32x	4,0x17

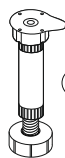

Z03-100
2x

136-170mm

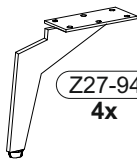

Z27-94
4x

150mm

Boden ohne Mittelseite

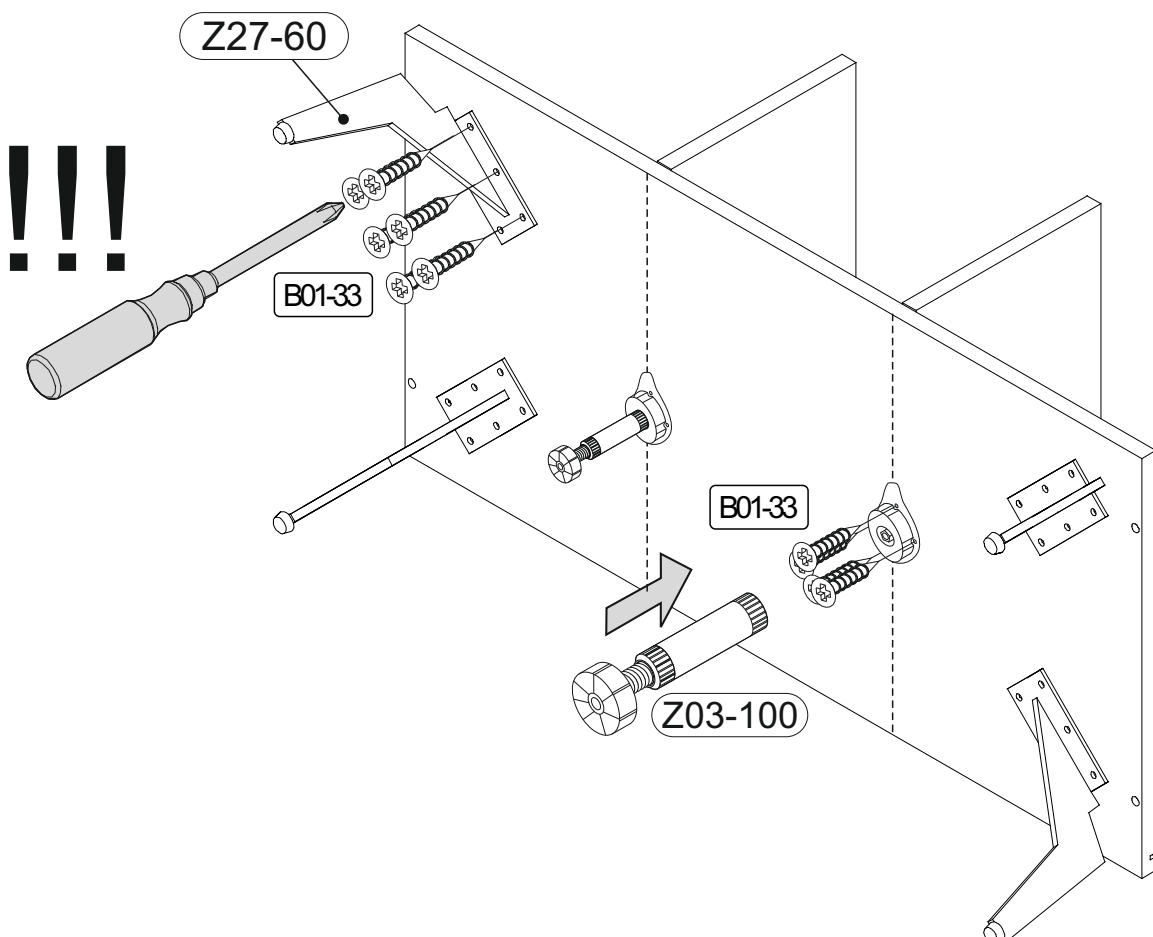
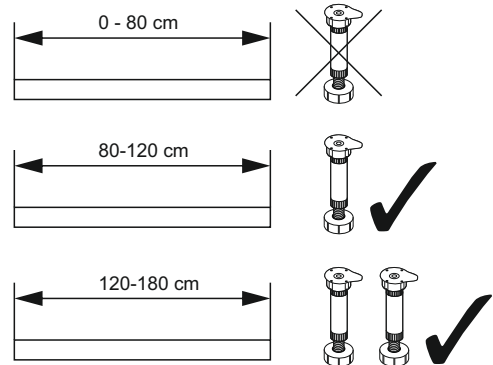



Schablone zum Auflegen auf den Boden

(hierzu die Ecken (**L=links weiß**) + (**R=rechts grau**) des Blattes mit den Kanten des Bodens bündig legen und mit einem Dorn die Löcher vorstechen.)

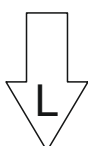
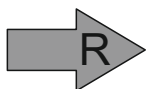
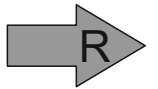
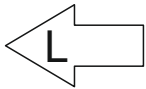



Colli 1/1

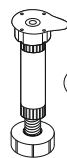
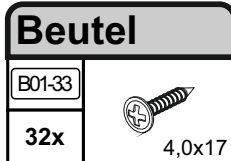

Z03-100
2x

136-170mm

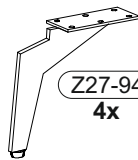

Z27-94
4x

150mm

Boden ohne Mittelseite

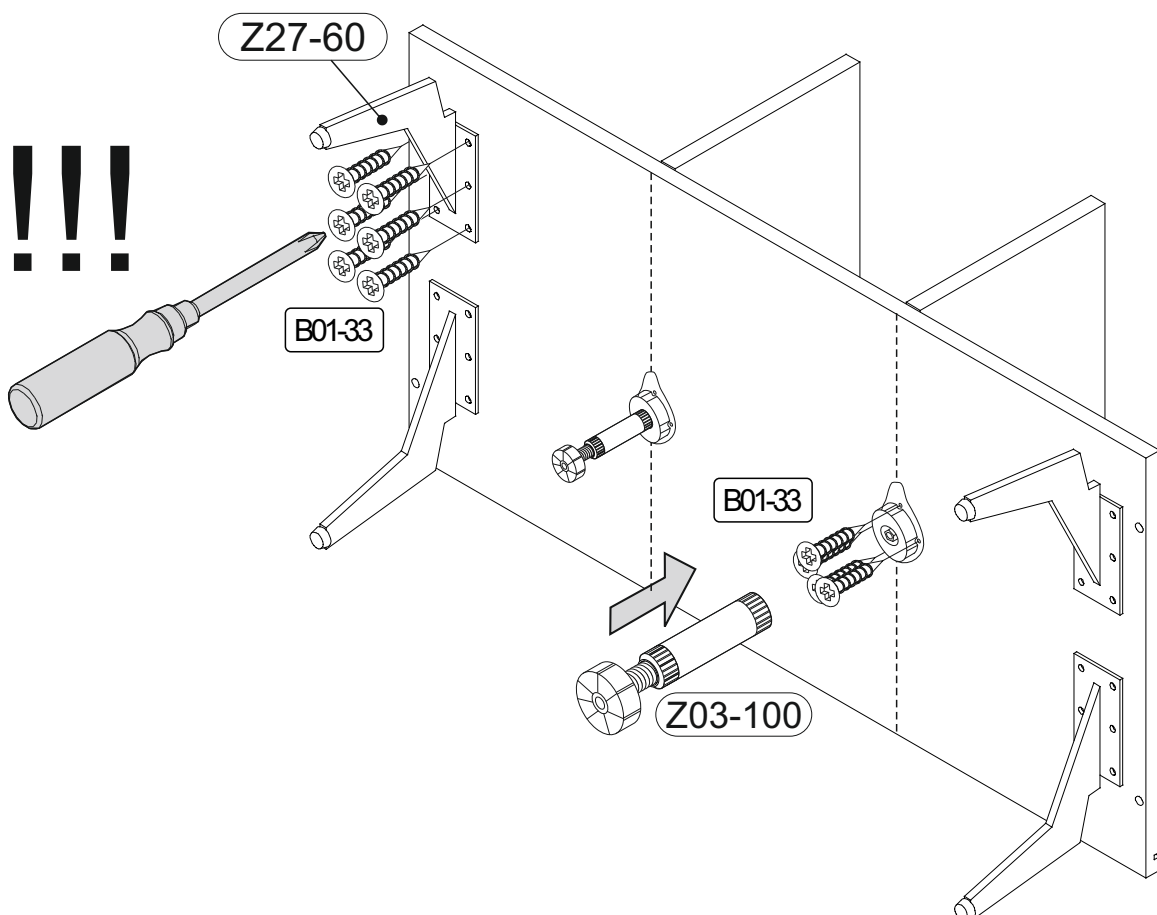
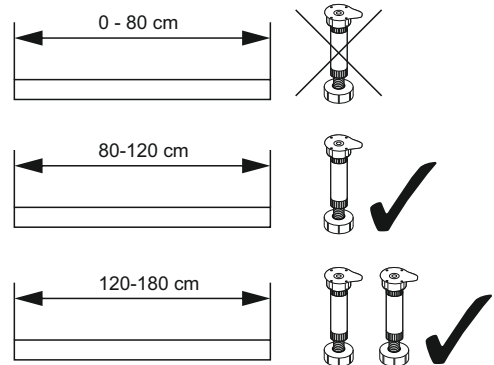

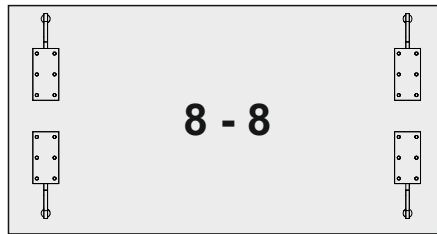

Schablone zum Auflegen auf den Boden

(hierzu die Ecken (L=links weiß) + (R=rechts grau) des Blattes mit den Kanten des Bodens bündig legen und mit einem Dorn die Löcher vorstechen.)

